

# ZAT440-FT LED

Pole mounted

**we-ef**

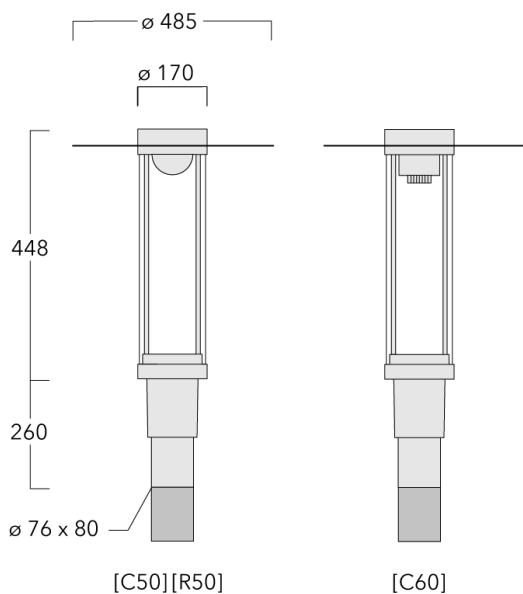

## Description

IP66, Class I. Class II on request. IK09. Marine-grade, die-cast aluminium alloy. 5CE superior corrosion protection including PCS hardware. Silicone CCG<sup>®</sup> Controlled Compression Gasket. PMMA main lens. Integral EC electronic converter in thermally separated compartment. DALI. CAD-optimised indirect optics for superior illumination and glare control. Factory installed LED circuit board. The luminaire is factory-sealed and does not need to be opened during installation.

## Fagerhult Lighting Ltd

33-34 Dolben Street, SE1 0UQ London, United Kingdom

<https://we-ef.com/uk>





Subject to technical changes and errors. - Generated on 24/11/2024

## Pole mounted

### Specifications

#### Material description

---

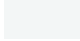
Body	Marine-grade, die-cast aluminium alloy
Lens	PMMA
Colours	 RAL9004 Signal black  RAL9006 White aluminium  RAL9007 Grey aluminium  RAL7016 Anthracite grey  RAL9016 Traffic white
Gasket	Silicone CCG® Controlled Compression Gasket
Fasteners	PCS Polymer Coated Stainless Steel Hardware
Ingress protection	IP66
Impact resistance	IK09
Corrosion resistance	5CE
Windage	0.160 m <sup>2</sup>

---

#### Electrical description

---

Power supply	220-240V / 50-60 Hz
Driver / Ballast	Integral EC electronic converter. DALI
Power factor	> 0.9
Surge protection	6/6 kV (optional SP10)

---

#### Additional information

---

Lifetime	Ta=25° L70B50 > 50000h
Energy efficiency class	C-D (Light source)

---

# ZAT440-FT LED

Pole mounted

**we-ef**

## Options

### Light distribution



controlled symmetric distribution [C50]



symmetric distribution [C60]



rectangular [R50]

### Colour temperature



2700 K



3000 K





4000 K

### Nominal Watt

24 W

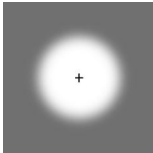
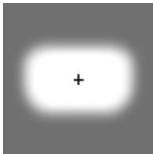
## Configurations

Light distribution	Part ID	Light source	Rated lumens	Rated input power	CRI	Weight (kg)
controlled symmetric distribution [C50] 	115-1688	LED-FT-12W / 350 mA - 2700 K	1491.3	14 W	80	7.80
	115-1689	LED-FT-12W / 350 mA - 3000 K	1592.2	14 W	80	7.80
	115-1690	LED-FT-12W / 350 mA - 4000 K	1677.7	14 W	80	7.80
	115-1691	LED-FT-17W / 500 mA - 2700 K	2279.6	20 W	80	7.80
	115-1692	LED-FT-17W / 500 mA - 3000 K	2384.5	20 W	80	7.80
	115-1693	LED-FT-17W / 500 mA - 4000 K	2485.4	20 W	80	7.80
	115-1694	LED-FT-24W / 700 mA - 2700 K	3145.6	27 W	80	7.80
	115-1695	LED-FT-24W / 700 mA - 3000 K	3277.7	27 W	80	7.80
	115-1696	LED-FT-24W / 700 mA - 4000 K	3417.5	27 W	80	7.80
	115-1697	LED-FT-37W / 700 mA - 2700 K	4772.8	42 W	80	7.80
	115-1698	LED-FT-37W / 700 mA - 3000 K	4916.5	42 W	80	7.80
115-1699	LED-FT-37W / 700 mA - 4000 K	5200	42 W	80	7.80	
rectangular [R50] 	115-1885	LED-FT-12W / 350 mA - 3000 K	1592.8	14 W	80	7.80
	115-1886	LED-FT-12W / 350 mA - 4000 K	1678.3	14 W	80	7.80
	115-1887	LED-FT-12W / 350 mA - 2700 K	1491.8	14 W	80	7.80
	115-1888	LED-FT-24W / 700 mA - 3000 K	3278.9	27 W	80	7.80
	115-1889	LED-FT-24W / 700 mA - 4000 K	3418.8	27 W	80	7.80
	115-1890	LED-FT-24W / 700 mA - 2700 K	3146.8	27 W	80	7.80
	115-1977	LED-FT-17W / 500 mA - 2700 K	2280.5	20 W	80	7.80
	115-1978	LED-FT-17W / 500 mA - 3000 K	2385.4	20 W	80	7.80
	115-1979	LED-FT-17W / 500 mA - 4000 K	2486.4	20 W	80	7.80
	115-2083	LED-FT-37W / 700 mA - 3000 K	4918.4	42 W	80	7.80
	115-2084	LED-FT-37W / 700 mA - 4000 K	5202	42 W	80	7.80
115-2085	LED-FT-37W / 700 mA - 2700 K	4774.6	42 W	80	7.80	
symmetric distribution [C60] 	115-1700	LED-FT-12W / 350 mA - 2700 K	1359.9	14 W	80	7.80
	115-1701	LED-FT-12W / 350 mA - 3000 K	1452	14 W	80	7.80
	115-1702	LED-FT-12W / 350 mA - 4000 K	1529.9	14 W	80	7.80
	115-1703	LED-FT-17W / 500 mA - 2700 K	2078.8	20 W	80	7.80
	115-1704	LED-FT-17W / 500 mA - 3000 K	2174.4	20 W	80	7.80
	115-1705	LED-FT-17W / 500 mA - 4000 K	2266.5	20 W	80	7.80
	115-1706	LED-FT-24W / 700 mA - 2700 K	2868.5	27 W	80	7.80
	115-1707	LED-FT-24W / 700 mA - 3000 K	2988.9	27 W	80	7.80
	115-1708	LED-FT-24W / 700 mA - 4000 K	3116.4	27 W	80	7.80
	115-1709	LED-FT-37W / 700 mA - 2700 K	4352.3	42 W	80	7.80
	115-1710	LED-FT-37W / 700 mA - 3000 K	4483.4	42 W	80	7.80

# ZAT440-FT LED

Pole mounted

**we-ef**

Light distribution	Part ID	Light source	Rated lumens	Rated input power	CRI	Weight (kg)
	115-1711	LED-FT-37W / 700 mA - 4000 K	4741.9	42 W	80	7.80

**Fagerhult Lighting Ltd**

33-34 Dolben Street, SE1 0UQ London, United Kingdom

<https://we-ef.com/uk>

Subject to technical changes and errors. - Generated on 24/11/2024

Pole mounted

### Optical Accessories

#### Light shield

---

Description	Part ID	H1
LS180-[C60]	159-0321	120

---



Pole mounted

## Mounting Accessories

### Wall and pole brackets RZ

Description	Part ID	C1	D1	D2	D × L1	M1	Weight (kg)
RZ0-400 Wall bracket, single	115-1324	277	231	195	76 x 80	12	3.50

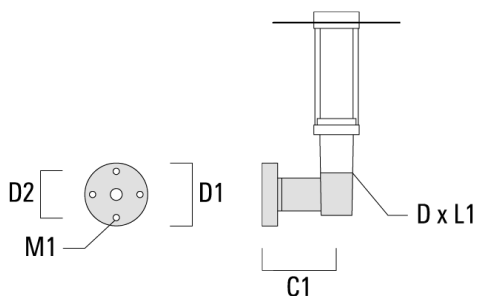

RZ2-400 Pole bracket, double	115-1323	258			76 x 100		4.90
------------------------------	----------	-----	--	--	----------	--	------

