

# DAC140 LED

## Ceiling Luminaires

**we-ef**

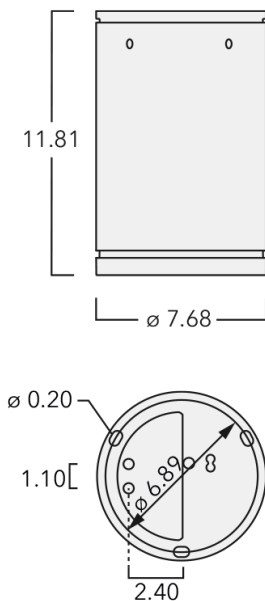

### Description

IP66, Class I. IK07. Marine-grade, die-cast aluminum alloy. 5CE superior corrosion protection including PCS hardware. Silicone CCG® Controlled Compression Gasket. Safety glass lens. Two cable entries. Integral driver, thermally separated. CAD-optimized optics for superior illumination and glare control. OLC® One LED Concept. Factory installed LED circuit board. 0-10V Dimming comes standard with luminaire.

Optional 2200 K version available, to be specified at time of ordering.

Specify product with 7 Digit product code - Finish Color. Accessories, such as mounting, optical, and electrical, must be specified separately.

Example: XXX-XXXX - 9004 (Black)  
+ XXX-XXXX (Accessory 1)

For DarkSky compliant configurations of this product, please find the spec sheet and DarkSky certificate in the library.

### WE-EF LIGHTING USA, LLC

410-D Keystone Drive, 15086 Warrendale, PA 15086 - Phone: +1 724 742 0030  
customersupport.usa@we-ef.com - <https://we-ef.com/us>  
Subject to technical changes and errors. - Generated on 08/15/2025

**Specifications****Material description**

Body	Marine-grade, all aluminium construction
Lens	Safety glass lens
Colors	<div><div></div> RAL9004 Black</div> <div><div></div> RAL9007 Grey Metallic</div> <div><div></div> RAL9016 White</div> <div><div></div> RAL8019 Dark Bronze</div>
Gasket	Silicone CCG® Controlled Compression Gasket
Fasteners	PCS Polymer Coated Stainless Steel Hardware
Ingress protection	IP66
Impact resistance	IK07
Corrosion resistance	5CE

**Electrical description**

Driver / Ballast	Integral EC electronic converter in thermally-separated compartment
Power factor	> 0.9

**Additional information**

Lifetime	Ta=25°/40° L90B10 > 90000h
Listings	Contact WE-EF USA for ETL/UL certification status.

DAC140 LED

Ceiling Luminaires



Options

Light distribution



symmetric, wide beam [W]



symmetric, medium beam [M]



symmetric, very narrow beam [VN]



symmetric, very narrow beam, 'sharp cut-off' [VNS]



wallwash [A20]

Color temperature

Nominal Watt



2700 K

0 W



3000 K





4000 K

WE-EF LIGHTING USA, LLC

410-D Keystone Drive, 15086 Warrendale, PA 15086 - Phone: +1 724 742 0030  
customersupport.usa@we-ef.com - <https://we-ef.com/us>  
Subject to technical changes and errors. - Generated on 08/15/2025

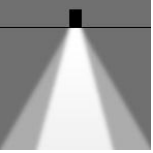
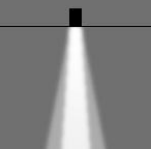
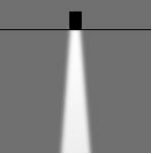
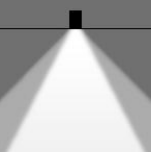
### Configurations

Light distribution	Part ID	Light source	Delivered lumens	Rated input power	CRI	Weight (lb)
symmetric, medium beam [M] 	134-2249	LED-24/48W / 700 mA - 2700 K	5378.5	54 W	80	5.50
	134-2250	LED-24/48W / 700 mA - 3000 K	5776.9	54 W	80	5.50
	134-2251	LED-24/48W / 700 mA - 4000 K	6175.3	54 W	80	5.50
symmetric, very narrow beam [VN] 	134-2252	LED-24/48W / 700 mA - 2700 K	5546.8	54 W	80	5.50
	134-2253	LED-24/48W / 700 mA - 3000 K	5957.7	54 W	80	5.50
	134-2254	LED-24/48W / 700 mA - 4000 K	6368.6	54 W	80	5.50
symmetric, very narrow beam, 'sharp cut-off' [VNS] 	134-2255	LED-24/48W / 700 mA - 2700 K	5785.2	54 W	80	5.50
	134-2256	LED-24/48W / 700 mA - 3000 K	6213.7	54 W	80	5.50
	134-2257	LED-24/48W / 700 mA - 4000 K	6642.2	54 W	80	5.50
symmetric, wide beam [W] 	134-2246	LED-24/48W / 700 mA - 2700 K	4916.1	54 W	80	5.50
	134-2247	LED-24/48W / 700 mA - 3000 K	5280.3	54 W	80	5.50
	134-2248	LED-24/48W / 700 mA - 4000 K	5644.5	54 W	80	5.50
wallwash [A20] 	134-2249+134-2065	LED-24/48W / 700 mA - 2700 K	4246.8	54 W	80	5.50
	134-2250+134-2065	LED-24/48W / 700 mA - 3000 K	4561.4	54 W	80	5.50
	134-2251+134-2065	LED-24/48W / 700 mA - 4000 K	4875.9	54 W	80	5.50

DAC140 LED

Ceiling Luminaires



Optical Accessories

Linear spread lens

Description	Part ID
IO-180-DAC140-LED	134-2064

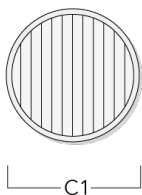

DAC140 LED

Ceiling Luminaires



Wallwash lens

Description	Part ID
IO-20-WW-DAC140-LED	134-2065

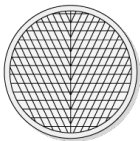

Honeycomb louvre

Description	Part ID
IW-DA_140-LED	134-2066

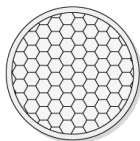

Mounting Accessories

Adaptor for side conduit entry

Description	Part ID	A	C1
DA14 Adaptor for DAC140/DAS140-PM	134-2109	1.20	7.70

