

145-7188

we-ef

FLC301 Spigot mounted



Description

IP66. IK07. Marine-grade, die-cast aluminium alloy. 5CE superior corrosion protection including PCS hardware. Safety glass lens. Silicone CCG® Controlled Compression Gasket. Luminaire is factory-sealed and does not need to be opened during installation.

Advanced thermal management protects LEDs while optimising lumens output. CAD-optimised optics for superior illumination and glare control. Including 5 ft of flexible PVC free cable.

Optical accessories are factory-installed. To be specified at time of ordering.

4W / 120V mains voltage version, ON-OFF Class I. Non-dimming.

6W / 24V DC low voltage version available upon request, ON-OFF Class III. Non-dimming.

Dimmable versions can only be done with a remote driver (120-277V)

347V remote driver on request.

| | |
|--------------------|----------------------------------|
| Weight | 0.70 lb |
| Light distribution | symmetric, very narrow beam [VN] |
| Light source | LED-1/4W / 350 mA - 4000 K |
| CRI | 80 |
| Power supply | electronic gear |
| LEDs | 1 |
| Rated input power | 5 W |

Rated lumens (lm)

| | |
|-------------|-------|
| LED Lumen | 449.5 |
| Total Lumen | 449.5 |
| Ta | 25 |

Nominal Lumen (lm)

| | |
|-------------|-----|
| LED Lumen | 530 |
| Total Lumen | 530 |
| Tc | 25 |

WE-EF LIGHTING USA, LLC

410-D Keystone Drive, 15086 Warrendale, PA 15086 - Phone: +1 724 742 0030

customersupport.usa@we-ef.com - <https://we-ef.com/us>

Subject to technical changes and errors. - Generated on 11/23/2024

145-7188



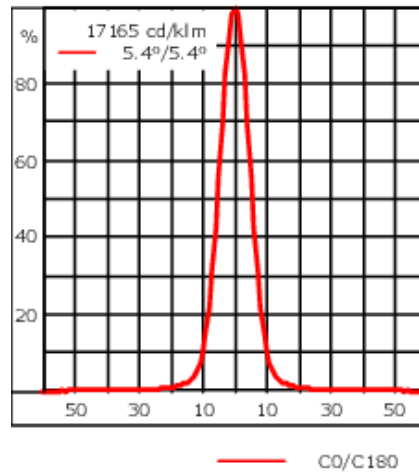
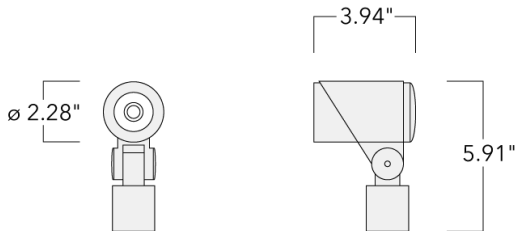

we-ef

FLC301 Spigot mounted



Specifications

Material description

| | |
|----------------------|--|
| Body | Marine-grade, die-cast aluminium alloy |
| Lens | Safety glass lens |
| Colors |  RAL9004 Black  RAL9007 Grey Metallic  RAL9016 White  RAL8019 Dark Bronze |
| Gasket | Silicone CCG® Controlled Compression Gasket |
| Fasteners | PCS hardware |
| Ingress protection | IP66 |
| Impact resistance | IK07 |
| Corrosion resistance | 5CE |
| Windage | 0.16 ft ² |

Electrical description

| | |
|------------------|--|
| Power supply | 120V AC/50-60 Hz (24V DC available upon request) |
| Driver / Ballast | Integral EC electronic converter (ON/OFF only) |
| Power factor | >0.9 |

WE-EF LIGHTING USA, LLC

410-D Keystone Drive, 15086 Warrendale, PA 15086 - Phone: +1 724 742 0030

customersupport.usa@we-ef.com - <https://we-ef.com/us>

Subject to technical changes and errors. - Generated on 11/23/2024

145-7188

we-ef

FLC301 Spigot mounted

Additional information

| | |
|----------|---|
| Lifetime | Ta=25°/40° L90B10 > 90000h |
| Dimming | 0-10V Dimming with Remote Driver only |
| Listings | ETL, UL-1598, CSA-C22.2#250.0. Suitable for Wet Locations |

WE-EF LIGHTING USA, LLC

410-D Keystone Drive, 15086 Warrendale, PA 15086 - Phone: +1 724 742 0030
customersupport.usa@we-ef.com - <https://we-ef.com/us>
Subject to technical changes and errors. - Generated on 11/23/2024

FLC301 Spigot mounted

Mounting Accessories

Threaded Nipple

| Description | Part ID | Weight (lb) |
|--------------------------|----------|-------------|
| 3/4 inch Threaded Nipple | 145-6903 | 0.24 |
| 1/2 inch Threaded Nipple | 145-6902 | 0.2 |

Flat surface and Column fitter

| Description | Part ID | A | B | D1 | D2 | M1 | Weight (lb) |
|----------------------|----------|----|---|-------|------|------|-------------|
| Column fitter FLC300 | 145-9536 | 70 | | ≥ 3.0 | 2.75 | 0.23 | .44 lbs |

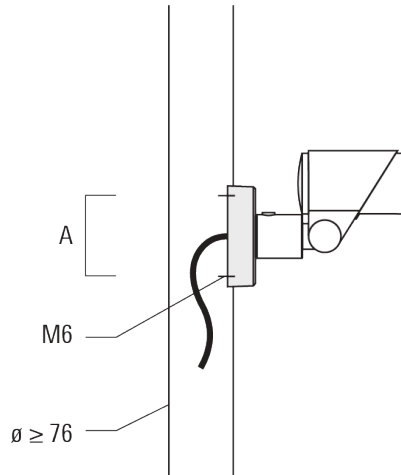

FLC301 Spigot mounted

| Description | Part ID | A | B | D1 | D2 | M1 | Weight (lb) |
|----------------------------|----------|-----|----|----|----|----|-------------|
| Flat surface fitter FLC300 | 145-9535 | 100 | 85 | | | | 0.20 |

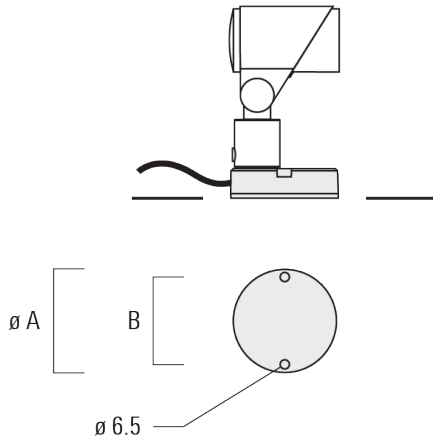

Ground spike EF

| Description | Part ID | A | Weight (lb) |
|-----------------------------|----------|-------|-------------|
| Ground spike EF1 for FLC300 | 310-9102 | 10.63 | 1.20 |

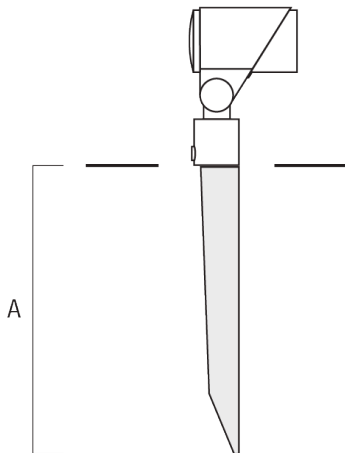

WE-EF LIGHTING USA, LLC

410-D Keystone Drive, 15086 Warrendale, PA 15086 - Phone: +1 724 742 0030
 customersupport.usa@we-ef.com - <https://we-ef.com/us>
 Subject to technical changes and errors. - Generated on 11/23/2024

FLC301 Spigot mounted

Junction box JB1

| Description | Part ID | A | B | C1 | D1 | Weight (lb) |
|----------------------------------|----------|------|------|------|------|-------------|
| Junction box JB1 with side entry | 310-9002 | 4.21 | 2.64 | 5.31 | 2.64 | 1.20 |

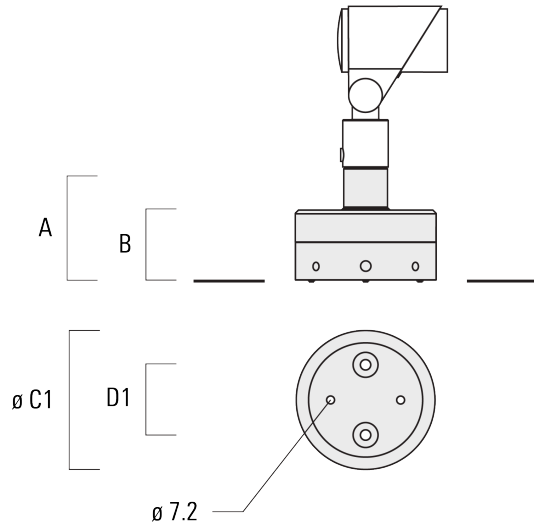

| | | | | | | |
|----------------------------------|----------|------|------|------|------|------|
| Junction box JB1 with wall entry | 310-9025 | 4.21 | 2.64 | 5.31 | 2.64 | 1.10 |
|----------------------------------|----------|------|------|------|------|------|

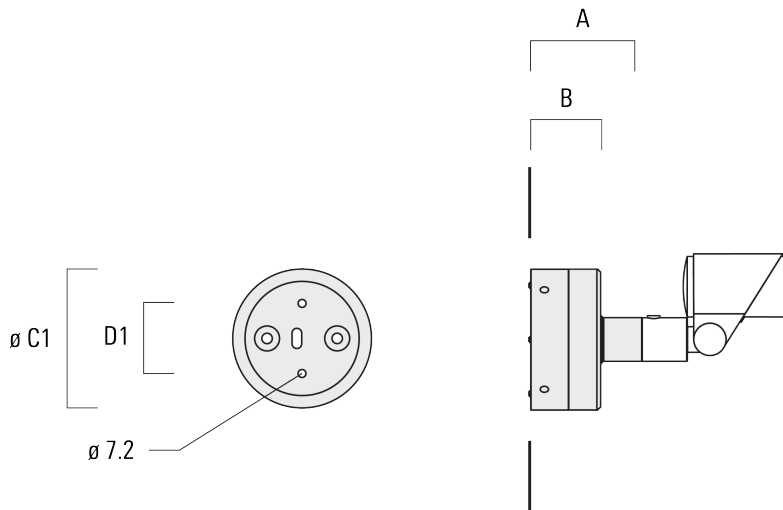

WE-EF LIGHTING USA, LLC

410-D Keystone Drive, 15086 Warrendale, PA 15086 - Phone: +1 724 742 0030
 customersupport.usa@we-ef.com - <https://we-ef.com/us>
 Subject to technical changes and errors. - Generated on 11/23/2024

145-7188

we-ef

FLC301 Spigot mounted

Optical Accessories

Linear spread lens

| Description | Part ID | C1 |
|---------------------------|----------|------|
| Linear spread lens IO-180 | 145-7229 | 42.5 |

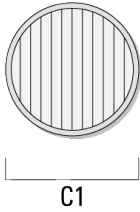

WE-EF LIGHTING USA, LLC

410-D Keystone Drive, 15086 Warrendale, PA 15086 - Phone: +1 724 742 0030
customersupport.usa@we-ef.com - <https://we-ef.com/us>
Subject to technical changes and errors. - Generated on 11/23/2024

145-7188

we-ef

FLC301 Spigot mounted

Wallwash lens

| Description | Part ID | C1 |
|---------------------|----------|------|
| Wallwash lens IO-20 | 145-7230 | 42.5 |

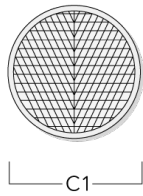

Honeycomb louvre

| Description | Part ID | C1 |
|---------------------|----------|------|
| Honeycomb louvre IW | 145-7231 | 42.5 |

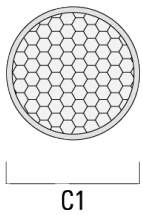

WE-EF LIGHTING USA, LLC

410-D Keystone Drive, 15086 Warrendale, PA 15086 - Phone: +1 724 742 0030
customersupport.usa@we-ef.com - <https://we-ef.com/us>
Subject to technical changes and errors. - Generated on 11/23/2024

FLC301 Spigot mounted

Glare shield

| Description | Part ID | A | C1 |
|-----------------|----------|------|----|
| Glare shield ES | 145-7232 | 20.5 | 58 |

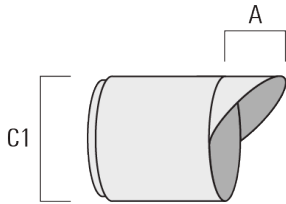

Snoot

| Description | Part ID | A | C1 |
|-------------|----------|------|----|
| Snoot ET | 145-7233 | 22.5 | 58 |

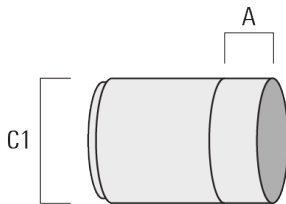

145-7188

we-ef

FLC301 Spigot mounted

Control

DALI interface

| Description | Part ID |
|----------------------------|---------|
| Low voltage DALI interface | 0026 |

Electronic converter

| Description | Part ID |
|---------------------------|---------|
| 24VDC low voltage version | 0025 |

WE-EF LIGHTING USA, LLC

410-D Keystone Drive, 15086 Warrendale, PA 15086 - Phone: +1 724 742 0030
customersupport.usa@we-ef.com - <https://we-ef.com/us>

Subject to technical changes and errors. - Generated on 11/23/2024