

145-7622

FLC311 Spigot mounted

**we-ef**



#### Description

IP66. IK08. Marine-grade, die-cast aluminium alloy. 5CE superior corrosion protection including PCS hardware. Safety glass lens. Silicone CCG® Controlled Compression Gasket. Luminaire is factory-sealed and does not need to be opened during installation.

Integral EC electronic converter. Advanced thermal management protects LEDs while optimising lumens output. CAD-optimised optics for superior illumination and glare control. Including 1.5 m of flexible PVC free cable.

Mains voltage versions: DALI interface

24VDC low voltage versions: ON-OFF Class III.

Remote 24VDC power supply to be ordered separately.

|                           |                                  |
|---------------------------|----------------------------------|
| Weight                    | 1.60 kg                          |
| Light distribution        | symmetric, very narrow beam [EE] |
| Light source              | LED-3/9W / 250 mA - 3000 K       |
| CRI                       | 80                               |
| Power supply              | EC                               |
| LEDs                      | 3                                |
| Rated input power         | 11 W                             |
| <b>Nominal Lumen (lm)</b> |                                  |
| LED Lumen                 | 365                              |
| Total Lumen               | 1095                             |
| T <sub>j</sub>            | 85                               |
| <b>Rated lumens (lm)</b>  |                                  |
| LED Lumen                 | 283.2                            |
| Total Lumen               | 849.6                            |
| T <sub>a</sub>            | 25                               |

**WE-EF LIGHTING Pty Ltd**

6/13 Downard Street, 3195 Braeside, Victoria - Phone: +61 3 8587 0444 - Fax: +61 3 8587 0499

info.australia@we-ef.com - <https://we-ef.com/aus>

Subject to technical changes and errors. - Generated on 23/11/2024

145-7622

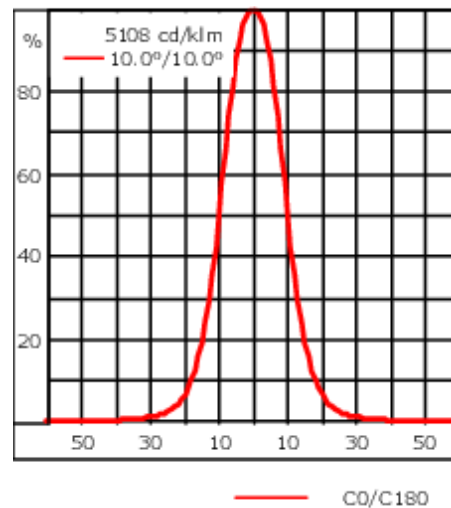
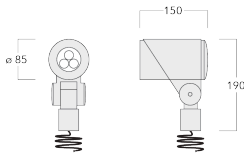

FLC311 Spigot mounted

**we-ef**



## Specifications

### Material description

|                      |   |
|----------------------|---|
| Body                 | Marine-grade, die-cast aluminium alloy  |
| Lens                 | Safety glass lens   |
| Colours              |  RAL9004 Signal black<br> RAL9006 White aluminium<br> RAL9007 Grey aluminium |
| Gasket               | Silicone CCG® Controlled Compression Gasket   |
| Fasteners            | PCS hardware  |
| Ingress protection   | IP66  |
| Impact resistance    | IK08  |
| Corrosion resistance | 5CE   |
| Windage              | 0.020 m <sup>2</sup>  |

### Electrical description

|                  |      |
|------------------|------|
| Driver / Ballast | DALI |
| Power factor     | >0.9 |

### Additional information

|          |                        |
|----------|------------------------|
| Lifetime | Ta=40° L90B10 > 90000h |
|----------|------------------------|

#### WE-EF LIGHTING Pty Ltd

6/13 Downard Street, 3195 Braeside, Victoria - Phone: +61 3 8587 0444 - Fax: +61 3 8587 0499

info.australia@we-ef.com - <https://we-ef.com/aus>

Subject to technical changes and errors. - Generated on 23/11/2024

**145-7622**

**FLC311 Spigot mounted**

**we-ef**

## **Control**

### **Eco Step Dim® Advanced**

| Description                | Part ID  |
|----------------------------|----------|
| Eco Step Dim® Advanced LED | 430-0002 |

### **0-10 V, 24VDC low voltage version**

| Description                       | Part ID |
|-----------------------------------|---------|
| 24VDC low voltage version, 0-10 V | 0033    |

**WE-EF LIGHTING Pty Ltd**

6/13 Downard Street, 3195 Braeside, Victoria - Phone: +61 3 8587 0444 - Fax: +61 3 8587 0499

info.australia@we-ef.com - <https://we-ef.com/aus>

Subject to technical changes and errors. - Generated on 23/11/2024

**FLC311 Spigot mounted**

**Mounting Accessories**

**Flat surface and Column fitter**

| Description          | Part ID  | A  | B | Weight (kg) |
|----------------------|----------|----|---|-------------|
| Column fitter FLC300 | 145-9536 | 70 |   | 0.20        |

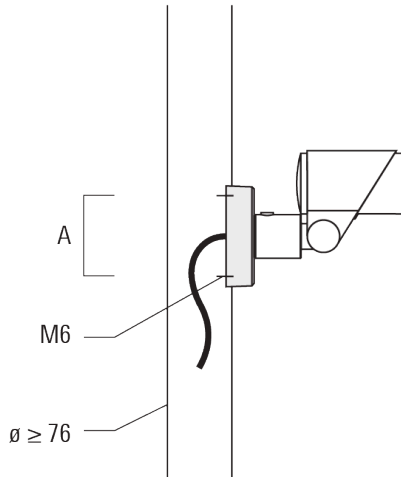

|                            |          |     |    |      |
|----------------------------|----------|-----|----|------|
| Flat surface fitter FLC300 | 145-9535 | 100 | 85 | 0.20 |
|----------------------------|----------|-----|----|------|

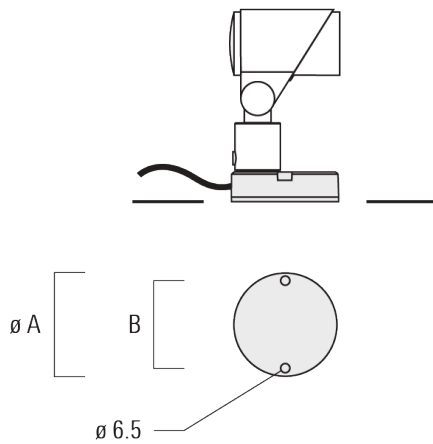

**FLC311 Spigot mounted**

**Ground spike EF**

| Description                 | Part ID  | A   | Weight (kg) |
|-----------------------------|----------|-----|-------------|
| Ground spike EF1 for FLC300 | 310-9102 | 270 | 1.20        |

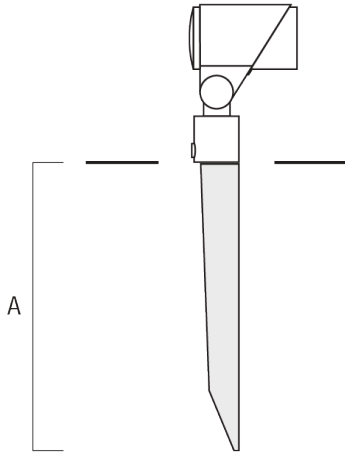

**Junction box JB1**

| Description                      | Part ID  | A   | B  | C1  | D1 | Weight (kg) |
|----------------------------------|----------|-----|----|-----|----|-------------|
| Junction box JB1 with side entry | 310-9002 | 107 | 67 | 135 | 67 | 1.20        |

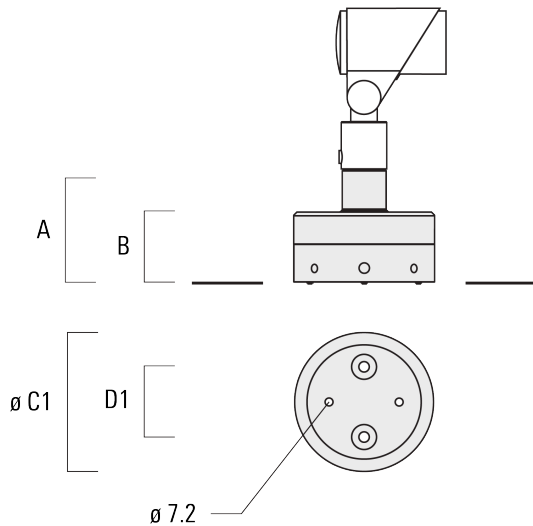

**FLC311 Spigot mounted**

| Description                      | Part ID  | A   | B  | C1  | D1 | Weight (kg) |
|----------------------------------|----------|-----|----|-----|----|-------------|
| Junction box JB1 with wall entry | 310-9025 | 107 | 67 | 135 | 67 | 1.10        |

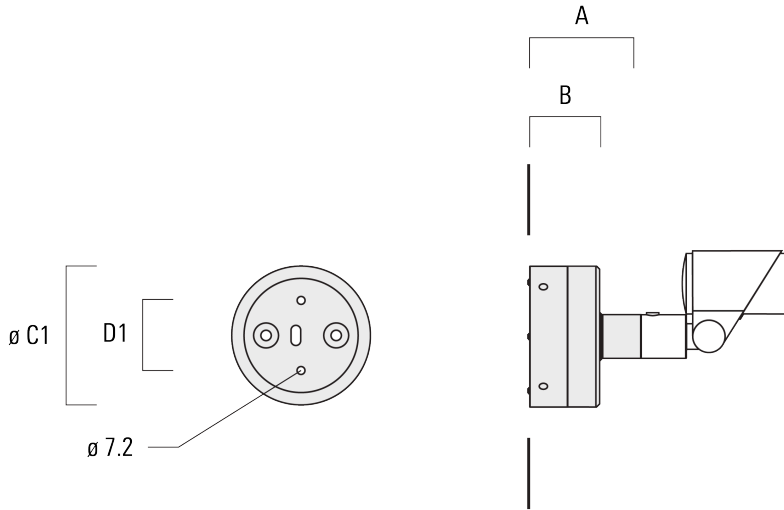

|   |          |     |    |     |    |      |
|---|----------|-----|----|-----|----|------|
| Junction box JB1 with side entry<br>(conduit) | 310-9022 | 107 | 67 | 135 | 67 | 1.20 |
|---|----------|-----|----|-----|----|------|

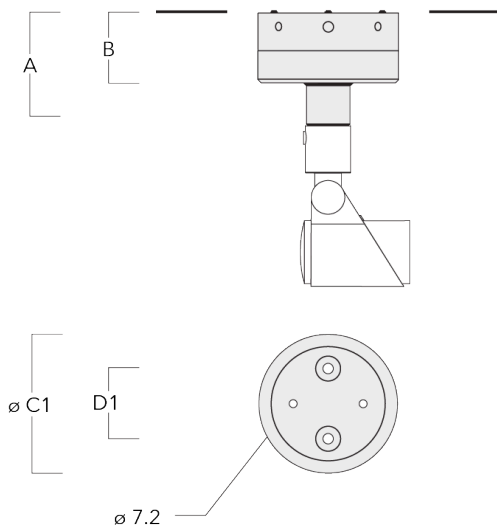

145-7622

FLC311 Spigot mounted

**we-ef**

## Optical Accessories

### Surface wash lens

| Description                | Part ID  | C1 |
|----------------------------|----------|----|
| Flood lens IO-360 for [EE] | 145-7786 | 59 |



|                             |          |    |
|-----------------------------|----------|----|
| Flood lens IO-360 for [EES] | 145-7780 | 59 |
|-----------------------------|----------|----|

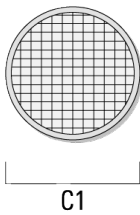

**WE-EF LIGHTING Pty Ltd**

6/13 Downard Street, 3195 Braeside, Victoria - Phone: +61 3 8587 0444 - Fax: +61 3 8587 0499

info.australia@we-ef.com - <https://we-ef.com/aus>

Subject to technical changes and errors. - Generated on 23/11/2024

145-7622

**FLC311 Spigot mounted**

**Linear spread lens**

---

| Description               | Part ID  | C1 |
|---------------------------|----------|----|
| Linear spread lens IO-180 | 145-7781 | 59 |

---

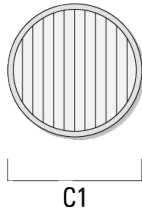

---

**Wallwash lens**

---

| Description         | Part ID  | C1 |
|---------------------|----------|----|
| Wallwash lens IO-20 | 145-7782 | 59 |

---

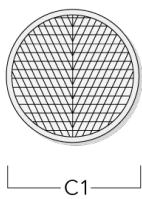



**FLC311 Spigot mounted**

**Honeycomb louvre**

---

| Description         | Part ID  | C1 |
|---------------------|----------|----|
| Honeycomb louvre IW | 145-7783 | 59 |

---

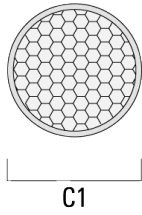

---

**Glare shield**

---

| Description     | Part ID  | A  | C1 |
|-----------------|----------|----|----|
| Glare shield ES | 145-7784 | 34 | 85 |

---

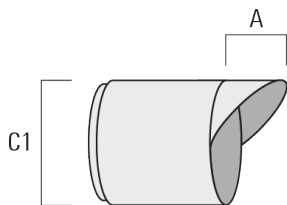

145-7622

**we-ef**

**FLC311 Spigot mounted**

**Snoot**

---

| Description | Part ID  | A  | C1 |
|-------------|----------|----|----|
| Snoot ET    | 145-7785 | 34 | 85 |

---

