



Description

IP66. IK08. Marine-grade, die-cast aluminium alloy. 5CE superior corrosion protection including PCS hardware. Safety glass lens. Silicone CCG® Controlled Compression Gasket. Luminaire is factory-sealed and does not need to be opened during installation.

Integral EC electronic converter. Advanced thermal management protects LEDs while optimising lumens output. CAD-optimised optics for superior illumination and glare control. Including 5 ft of flexible PVC free cable.

Optical accessories are factory-installed. To be specified at time of ordering.

12W, 18W, 26W / 120-277V / 0-10V Dimming.
12W, 18W / 24V DC / 0-10V Dimming. (available upon request)

Contact the factory for 277V/347V options.

| | |
|--------------------|------------------------------|
| Weight | 5.70 lb |
| Light distribution | symmetric, wide beam [W] |
| Light source | LED-6/18W / 1050 mA - 3000 K |
| CRI | 80 |
| Power supply | electronic gear |
| LEDs | 6 |
| Rated input power | 21 W |

| Nominal Lumen (lm) | |
|--------------------|------|
| LED Lumen | 405 |
| Total Lumen | 2430 |
| Tj | 85 |

| Delivered lumens (lm) | |
|-----------------------|--------|
| LED Lumen | 221.9 |
| Total Lumen | 1331.7 |
| Ta | 25 |

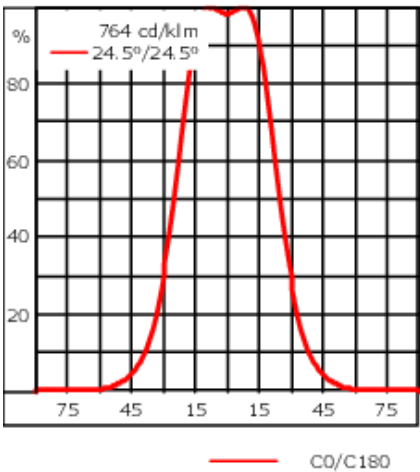
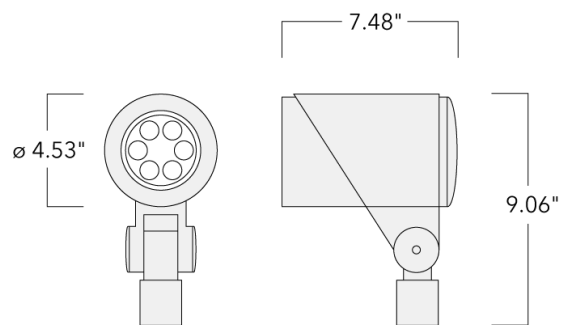

Specifications

Material description

| | |
|----------------------|---|
| Body | Marine-grade, die-cast aluminium alloy |
| Lens | Safety glass lens |
| Colors | <div><div></div> RAL9004 Black</div> <div><div></div> RAL9007 Grey Metallic</div> <div><div></div> RAL9016 White</div> <div><div></div> RAL8019 Dark Bronze</div> |
| Gasket | Silicone CCG® Controlled Compression Gasket |
| Fasteners | PCS hardware |
| Ingress protection | IP66 |
| Impact resistance | IK08 |
| Corrosion resistance | 5CE |
| Windage | 0.43 ft² |

Electrical description

| | |
|------------------|---|
| Power supply | 120-277V AC/50-60 Hz (24VDC available upon request) |
| Driver / Ballast | 120-277V AC/50-60 Hz (24VDC available upon request) |
| Power factor | >0.9 |

145-9946



FLC321 Spigot mounted

Additional information

| | |
|----------|--|
| Lifetime | Ta=25°/40° L90B10 > 90000h |
| Dimming | 0-10V |
| Listings | ETL, UL-1598, CSA-C22.2#250.0. Suitable for Wet Locations. |

Mounting Accessories

Threaded Nipple

| Description | Part ID | Weight (lb) |
|--------------------------|----------|-------------|
| 3/4 inch Threaded Nipple | 145-6903 | 0.24 |
| 1/2 inch Threaded Nipple | 145-6902 | 0.2 |

Flat surface and Column fitter

| Description | Part ID | A | B | D1 | D2 | M1 | Weight (lb) |
|----------------------|----------|----|---|-------|------|------|-------------|
| Column fitter FLC300 | 145-9536 | 70 | | ≥ 3.0 | 2.75 | 0.23 | .44 lbs |

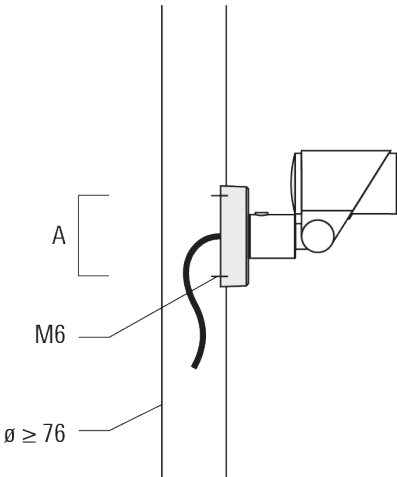

FLC321 Spigot mounted

| Description | Part ID | A | B | D1 | D2 | M1 | Weight (lb) |
|----------------------------|----------|-----|----|----|----|----|-------------|
| Flat surface fitter FLC300 | 145-9535 | 100 | 85 | | | | 0.20 |

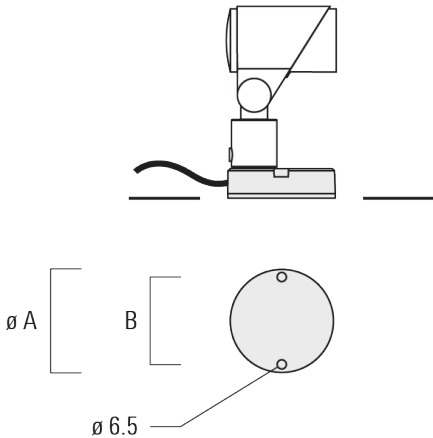

Ground spike EF

| Description | Part ID | A | Weight (lb) |
|-----------------------------|----------|-------|-------------|
| Ground spike EF1 for FLC300 | 310-9102 | 10.63 | 1.20 |

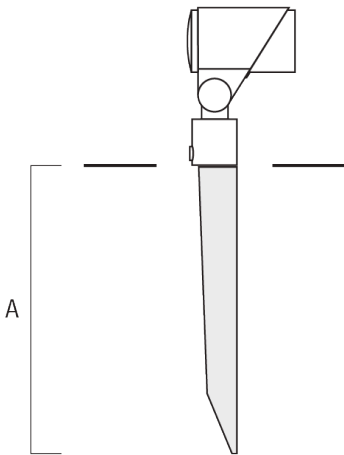

FLC321 Spigot mounted

Junction box JB1

| Description | Part ID | A | B | C1 | D1 | Weight (lb) |
|----------------------------------|----------|------|------|------|------|-------------|
| Junction box JB1 with side entry | 310-9002 | 4.21 | 2.64 | 5.31 | 2.64 | 1.20 |

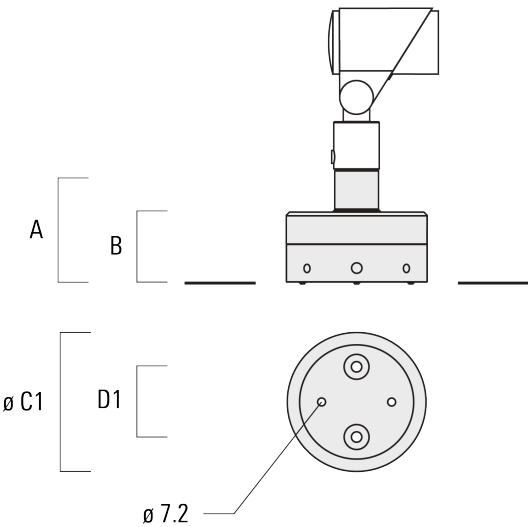

| | | | | | | |
|----------------------------------|----------|------|------|------|------|------|
| Junction box JB1 with wall entry | 310-9025 | 4.21 | 2.64 | 5.31 | 2.64 | 1.10 |
|----------------------------------|----------|------|------|------|------|------|

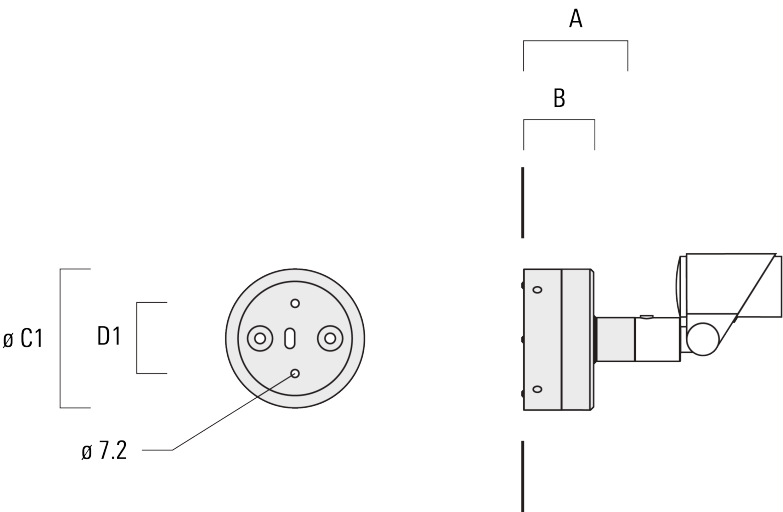

FLC321 Spigot mounted

| Description | Part ID | A | B | C1 | D1 | Weight (lb) |
|---|----------|------|------|------|------|-------------|
| Junction box JB1 with side entry (conduit) | 310-9022 | 4.21 | 2.64 | 5.31 | 2.64 | 1.20 |

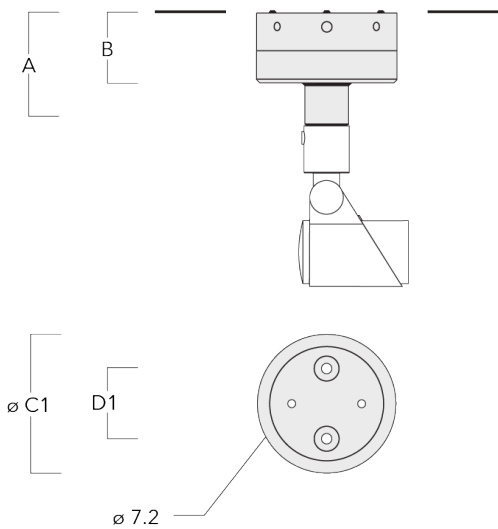

145-9946



FLC321 Spigot mounted

Control

DALI interface

| Description | Part ID |
|----------------------------|---------|
| Low voltage DALI interface | 0026 |

0-10 V, 24VDC low voltage version

| Description | Part ID |
|-----------------------------------|---------|
| 24VDC low voltage version, 0-10 V | 0033 |

Optical Accessories

Softening Lens

| Description | Part ID | C1 |
|-------------------|----------|------|
| Flood lens IO-360 | 145-9992 | 3.43 |



FLC321 Spigot mounted

Linear spread lens

| Description | Part ID | C1 |
|---------------------------|----------|------|
| Linear spread lens IO-180 | 145-9991 | 3.43 |



Wallwash lens

| Description | Part ID | C1 |
|---------------------|----------|------|
| Wallwash lens IO-20 | 145-9993 | 3.43 |

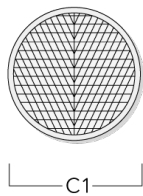

FLC321 Spigot mounted

Honeycomb louvre

| Description | Part ID | C1 |
|---------------------|----------|------|
| Honeycomb louvre IW | 145-9994 | 3.43 |



Glare shield

| Description | Part ID | A | C1 |
|-----------------|----------|------|------|
| Glare shield ES | 145-9995 | 2.17 | 4.49 |



FLC321 Spigot mounted

Snoot

| Description | Part ID | A | C1 |
|-------------|----------|------|------|
| Snoot ET | 145-9996 | 2.20 | 4.49 |

