

145-7636

FLC311 Surface mounted

**we-ef**



#### Description

IP66. IK08. Marine-grade, die-cast aluminium alloy. 5CE superior corrosion protection including PCS hardware. Safety glass lens. Silicone CCG® Controlled Compression Gasket. Luminaire is factory-sealed and does not need to be opened during installation.

Integral EC electronic converter. Advanced thermal management protects LEDs while optimising lumens output. CAD-optimised optics for superior illumination and glare control. One cable entry.

Optical accessories are factory-installed. To be specified at time of ordering.

6-12W / 120V / 0-10V Dimming.  
6W / 24V DC / 0-10V Dimming. (available upon request)

Contact the factory for 277V or 347V options.

|                           |                            |
|---------------------------|----------------------------|
| Weight                    | 2.20 lb                    |
| Light distribution        | symmetric, wide beam [W]   |
| Light source              | LED-3/6W / 180 mA - 2700 K |
| CRI                       | 80                         |
| Power supply              | electronic gear            |
| LEDs                      | 3                          |
| Rated input power         | 7.5 W                      |
| <b>Nominal Lumen (lm)</b> |                            |
| LED Lumen                 | 260                        |
| Total Lumen               | 780                        |
| Tj                        | 85                         |
| <b>Rated lumens (lm)</b>  |                            |
| LED Lumen                 | 198.5                      |
| Total Lumen               | 595.4                      |
| Ta                        | 25                         |

#### WE-EF LIGHTING USA, LLC

410-D Keystone Drive, 15086 Warrendale, PA 15086 - Phone: +1 724 742 0030  
customersupport.usa@we-ef.com - <https://we-ef.com/us>  
Subject to technical changes and errors. - Generated on 10/23/2024

145-7636

**we-ef**

**FLC311 Surface mounted**

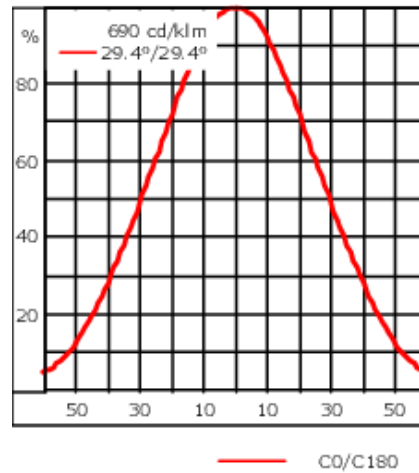
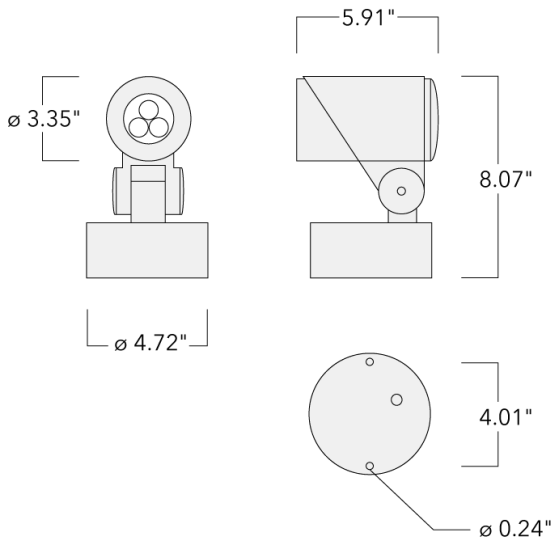

**Specifications**

**Material description**

|                      |   |
|----------------------|---|
| Body                 | Marine-grade, die-cast aluminium alloy  |
| Lens                 | Safety glass lens   |
| Colors               | <div style="display: flex; flex-direction: column; gap: 5px;"> <div><span style="display: inline-block; width: 15px; height: 15px; background-color: black; margin-right: 5px;"></span> RAL9004 Black</div> <div><span style="display: inline-block; width: 15px; height: 15px; background-color: grey; margin-right: 5px;"></span> RAL9007 Grey Metallic</div> <div><span style="display: inline-block; width: 15px; height: 15px; background-color: white; margin-right: 5px;"></span> RAL9016 White</div> <div><span style="display: inline-block; width: 15px; height: 15px; background-color: darkgrey; margin-right: 5px;"></span> RAL8019 Dark Bronze</div> </div> |
| Gasket               | Silicone CCG® Controlled Compression Gasket   |
| Fasteners            | PCS hardware  |
| Ingress protection   | IP66  |
| Impact resistance    | IK08  |
| Corrosion resistance | 5CE   |
| Windage              | 0.269 ft <sup>2</sup>   |

**Electrical description**

|                  |   |
|------------------|---|
| Power supply     | 120-277VAC/50-60 Hz (24V DC available upon request)                                     |
| Driver / Ballast | Integral [ECG] electronic driver 120V-277V. (24VDC low voltage, available upon request) |
| Power factor     | >0.9  |

**WE-EF LIGHTING USA, LLC**

410-D Keystone Drive, 15086 Warrendale, PA 15086 - Phone: +1 724 742 0030

customersupport.usa@we-ef.com - <https://we-ef.com/us>

Subject to technical changes and errors. - Generated on 10/23/2024

**145-7636**

**we-ef**

**FLC311 Surface mounted**

**Additional information**

---

|          |  |
|----------|--|
| Lifetime | Ta=25°/40° L90B10 > 90000h                                 |
| Dimming  | 0-10V Dimming as standard                                  |
| Listings | ETL, UL-1598, CSA-C22.2#250.0. Suitable for Wet Locations. |

---

**WE-EF LIGHTING USA, LLC**

410-D Keystone Drive, 15086 Warrendale, PA 15086 - Phone: +1 724 742 0030

customersupport.usa@we-ef.com - <https://we-ef.com/us>

Subject to technical changes and errors. - Generated on 10/23/2024

145-7636

**we-ef**

FLC311 Surface mounted

### Mounting Accessories

#### Planted root

| Description       | Part ID  | D1   | D2   | D3   | D4   | H1    | H2    | M1  | Weight (lb) |
|-------------------|----------|------|------|------|------|-------|-------|-----|-------------|
| Planted root ESV4 | 300-0461 | 5.71 | 5.12 | 4.01 | 4.25 | 15.75 | 13.78 | .31 | 15.50       |

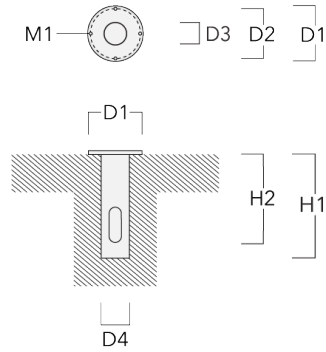

#### Short post EM

**WE-EF LIGHTING USA, LLC**

410-D Keystone Drive, 15086 Warrendale, PA 15086 - Phone: +1 724 742 0030

customersupport.usa@we-ef.com - <https://we-ef.com/us>

Subject to technical changes and errors. - Generated on 10/23/2024

**FLC311 Surface mounted**

| Description                   | Part ID  | A    | B    | C1   | D1   | Weight (lb) |
|-------------------------------|----------|------|------|------|------|-------------|
| Short post EM1 for FLC311/321 | 146-7169 | 1.02 | 7.87 | 4.72 | 6.30 | 3.97        |

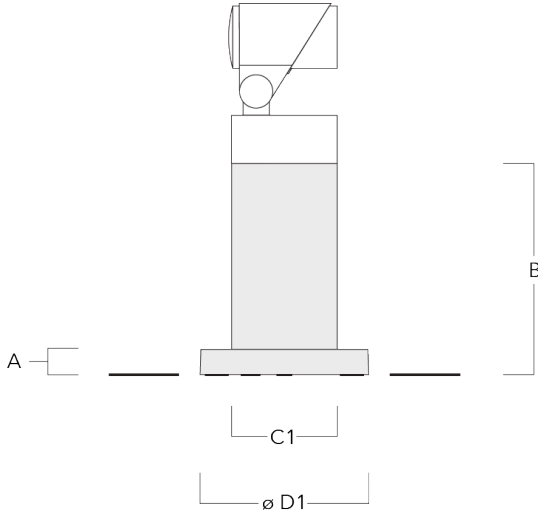

**Pole clamp SP**

| Description                         | Part ID  | D1    | Weight (lb) |
|-------------------------------------|----------|-------|-------------|
| Pole clamp SP1-M5, single (Ø 38-60) | 146-7201 | 38-60 | 1.20        |

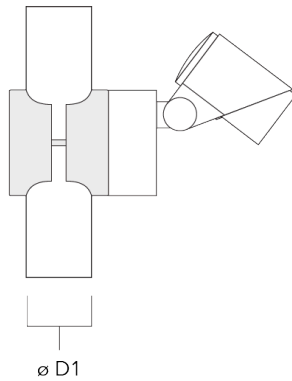

**WE-EF LIGHTING USA, LLC**

410-D Keystone Drive, 15086 Warrendale, PA 15086 - Phone: +1 724 742 0030

customersupport.usa@we-ef.com - <https://we-ef.com/us>

Subject to technical changes and errors. - Generated on 10/23/2024

**FLC311 Surface mounted**

---

| Description                         | Part ID  | D1    | Weight (lb) |
|-------------------------------------|----------|-------|-------------|
| Pole clamp SP1-M5, single (Ø 76-89) | 146-7202 | 76-89 | 1.10        |

---

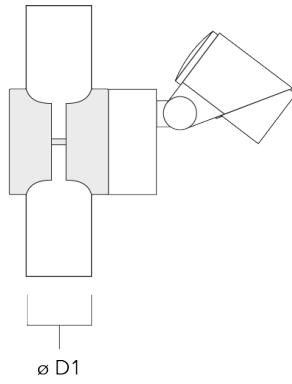

---

|                                     |          |       |      |
|-------------------------------------|----------|-------|------|
| Pole clamp SP2-M5, single (Ø 38-60) | 146-7203 | 38-60 | 1.30 |
|-------------------------------------|----------|-------|------|

---

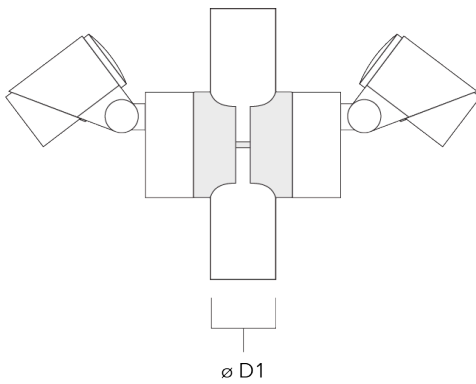

**WE-EF LIGHTING USA, LLC**

410-D Keystone Drive, 15086 Warrendale, PA 15086 - Phone: +1 724 742 0030

customersupport.usa@we-ef.com - <https://we-ef.com/us>

Subject to technical changes and errors. - Generated on 10/23/2024

**FLC311 Surface mounted**

---

| Description                         | Part ID  | D1    | Weight (lb) |
|-------------------------------------|----------|-------|-------------|
| Pole clamp SP2-M5, single (Ø 76-89) | 146-7204 | 76-89 | 1.20        |

---

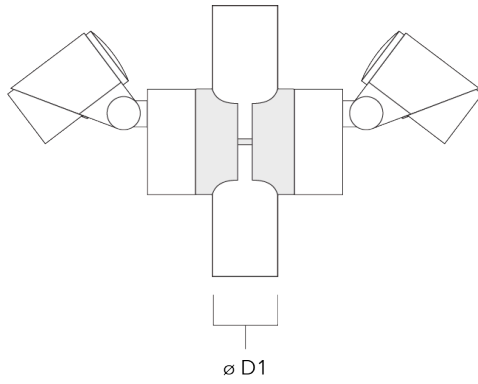

**WE-EF LIGHTING USA, LLC**

410-D Keystone Drive, 15086 Warrendale, PA 15086 - Phone: +1 724 742 0030

customersupport.usa@we-ef.com - <https://we-ef.com/us>

Subject to technical changes and errors. - Generated on 10/23/2024

**145-7636**

**we-ef**

**FLC311 Surface mounted**

**Control**

**0-10 V, 24VDC low voltage version**

---

| Description                       | Part ID |
|-----------------------------------|---------|
| 24VDC low voltage version, 0-10 V | 0033    |

---

**WE-EF LIGHTING USA, LLC**

410-D Keystone Drive, 15086 Warrendale, PA 15086 - Phone: +1 724 742 0030

customersupport.usa@we-ef.com - <https://we-ef.com/us>

Subject to technical changes and errors. - Generated on 10/23/2024



**145-7636**

**FLC311 Surface mounted**

**WE-EF LIGHTING USA, LLC**

410-D Keystone Drive, 15086 Warrendale, PA 15086

Phone: +1 724 742 0030

[customersupport.usa@we-ef.com](mailto:customersupport.usa@we-ef.com)

<https://we-ef.com/us>

Subject to technical changes and errors.

Generated on 10/23/2024

**we-ef**

---

A Fagerhult Group Company