

**we-ef**



**WE-EF LIGHTING**

Installation and Maintenance  
Instructions for Projectors

**FLC200 LED Series**  
**FLC200-CC LED Series**  
**FLC200-TW LED Series**  
**FLC200-CC Wireless DMX Series**



**WARNING:**

This product to be installed by qualified personnel only.

**Switch off and isolate the electrical supply during installation.**

At no stage is the luminaire to be opened when live.

Connections and cables are labelled, before installation ensure the supply matches the luminaire designation.

**ESD Sensitive Device:**

This luminaire contains electrostatic sensitive devices. Do not handle the LED PCB or LED connection leads without suitable ESD prevention methods in place. If in doubt contact WE-EF LIGHTING or an authorised Sales partner. Warranty can be void if the correct handling procedures are not observed.

**Surge Protection:**

For comprehensive protection of a luminaire installation against lightning and electrical surges, it is essential to cover mains supply and data input lines at the distribution board level, by using respective primary (Type 1) and secondary (Type 2) surge arrestors in compliance with EN61643-11/IEC61643-1.

Luminaires designated with the type code '+A' will have an internal Surge Protection Device (SPD) fitted. Street and area luminaries are supplied with an external SPD.

Where an external SPD is supplied, it must be fitted as per the supplied instructions to maintain warranty conditions.

Ensure that all required surge protection measures are in place and activated prior to luminaire installation. Disconnect luminaires before operating high-power devices such as, for example, electrical arc welders.

**Cleaning:**

Apart from cleaning the product's exterior surfaces, no special maintenance work is required. **DO NOT** use high pressure cleaners on this luminaire

**Notice:**

Unless directed by this installation instruction, the luminaire is to be treated as Factory Sealed with no user serviceable parts. If the luminaire is modified by anybody other than the original manufacturer, the warranty will no longer be valid and shall become the full responsibility of the modifying person/organisation. Claims based on defects attributable to improper installation and/or application, and the consequences thereof, are also excluded.

## Projectors

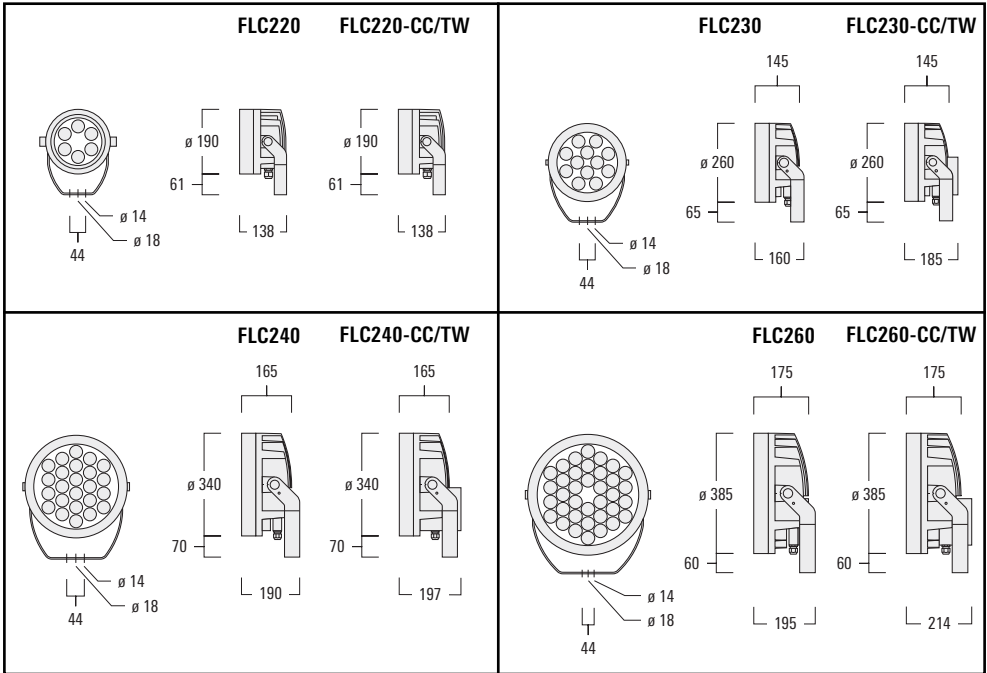

### Light source

FLC220	6 LED 12W / 18W / 24W
FLC230	12 LED 24W / 36W / 52W
FLC240	24 LED 48W / 72W / 104W
FLC260	36 LED 72W / 108 W / 155W
FLC220-TW	6 LED 22W
FLC230-TW	12 LED 44W
FLC240-TW	24 LED 88W
FLC260-TW	36 LED 136W
FLC220-CC	6 LED 24W
FLC230-CC	12 LED 48W
FLC240-CC	24 LED 96W
FLC260-CC	36 LED 144W

### Windage area

FLC220	0,030 m <sup>2</sup>
FLC230	0,054 m <sup>2</sup>
FLC240	0,090 m <sup>2</sup>
FLC260	0,116 m <sup>2</sup>

### Weight:

FLC220	max. 4,5 kg
FLC230	max. 8,0 kg
FLC240	max. 13,8 kg
FLC260	max. 18,8 kg



### Tools required

- Screwdriver TX25 / TX30 / TX70
- Screwdriver with blade 3x1

Protection: IP66, IK07

Class I, ta = 25°C

## Installation

The product must be installed and maintained by a suitably qualified professional in compliance with latest building/ construction and/or electrical regulations and relevant legislation.

**⚡ Warning:** Switch off and isolate mains electrical supply prior to installing and connecting the luminaire. Do not open the luminaire while mains supply is switched on.

**Notice:** If the luminaire is modified by anybody other than the original manufacturer, then the warranty will no longer be valid and shall become the full responsibility of the modifying person/organisation. Claims based on defects attributable to improper installation and/or application, and the consequences thereof, are excluded.

In case of component failure due to abnormal circumstances or at end of life, replacement must be carried out by a suitably qualified and trained professional.

In case of questions please contact our technical hotline: +61 458 933 399 (from Monday - Friday from 07.00 until 19.00 hours).

## Installation Procedure

1) Prior to electrical connection, proceed with mechanical installation by firmly fixing stirrup **A** to optional mounting accessory or directly to a suitable surface.

Aim luminaire.

**Caution:** Make sure not to damage any electric cable, water pipe or other devices while drilling holes.

- 2) Switch off and isolate the mains electrical supply. ⚡
- 3) Remove gear box cover **B** by releasing screws **C**.
- 4) Check that rating shown on the luminaire label conforms with the mains electrical supply.

- 5) Feed mains supply cable **D** through cable gland **E**. An additional M20 gland is supplied to allow loop through of supply cabling or alternative DMX cabling arrangements.
- 6) Connect to the correspondingly marked contacts of terminal **F**, according to the wiring diagram. Tighten cable gland **E** firmly.
- 7) Reposition gear box cover **B** and tighten screws **C** evenly.
- 8) Loosen the two screws **G** slightly. Aim luminaire (see illustration), tighten screws **G** firmly (**100Nm**). In addition, tighten screw **H** (max. **6Nm**) to secure orientation of luminaire.

## Torque

Screw	Torque
TX20	max. 2,0 Nm
TX25	max. 4,0 Nm
TX27	max. 6,0 Nm
TX30	max. 15,0 Nm
TX70	max. 100,0 Nm

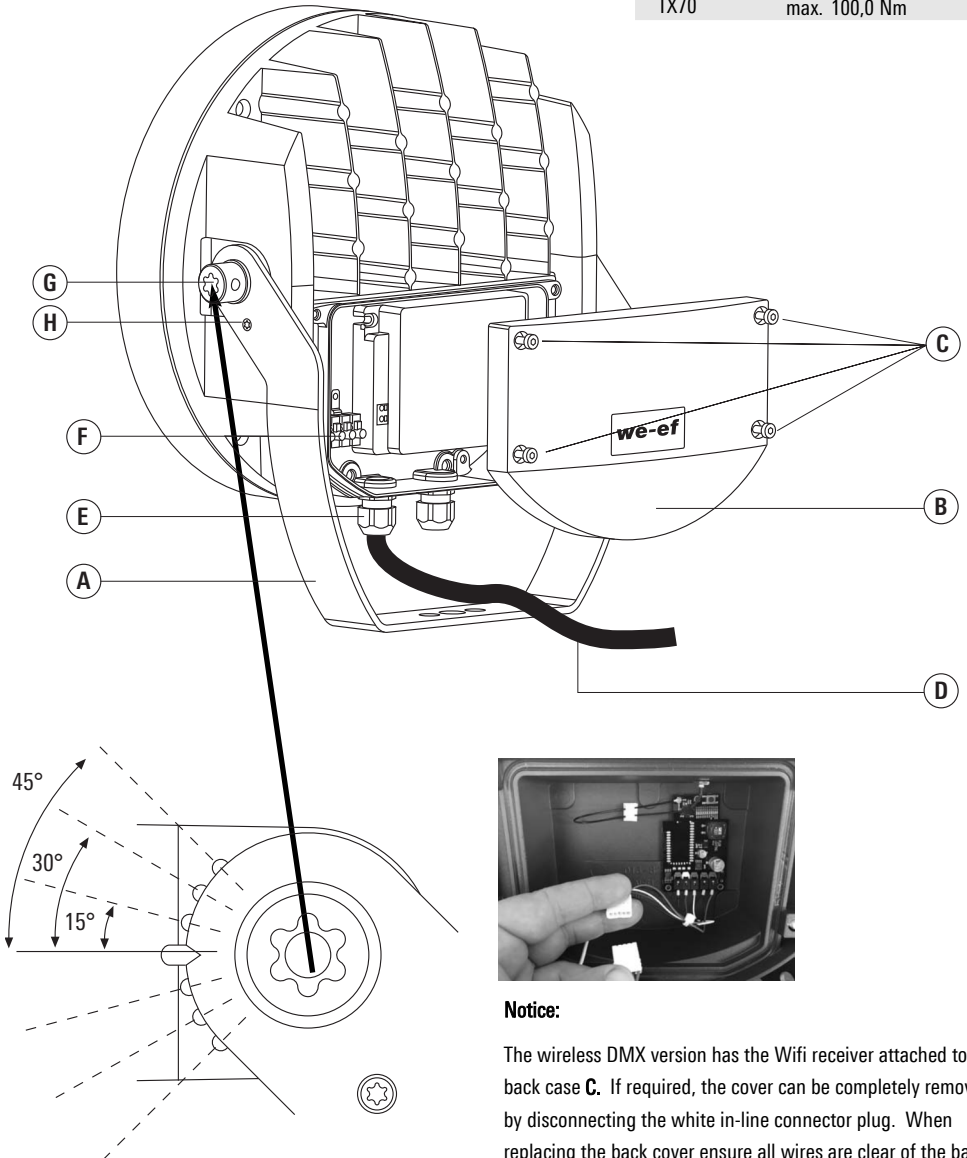

### Notice:

The wireless DMX version has the Wifi receiver attached to the back case **C**. If required, the cover can be completely removed by disconnecting the white in-line connector plug. When replacing the back cover ensure all wires are clear of the back case sealing rib.

## Wiring Diagram

### WE-EF Advanced, CC Wireless DMX, DALI CASAMBI and non dimmable luminaires

Class I → Phase to **L1**, Neutral to **N** and Earthing to ⊕

For DALI CASAMBI applications, **4remote BT** app is required to commission or control luminaires, scan QR code to download app to mobile device (iOS or Android required).



Class II → Phase to **L1**, Neutral to **N**

### WE-EF Basic

Class I → Phase to **L1**, Control Phase to **L2**,  
Neutral to **N** and Earthing to ⊕

Class II → Phase to **L1**, Control Phase to **L2**, Neutral to **N**

### 1-10V / DALI (INC TW) / CC (DMX)

Class I → Phase to **L1**, Neutral to **N** and Earthing to ⊕,  
1-10V, DMX to **+** and 1-10V, DMX to **-**  
DALI to **D**

Class II → Phase to **L1**, Neutral to **N**,  
1-10V, DMX to **+** and 1-10V, DMX to **-**  
for DMX shield on '**S**'

DALI to **D**

ON-OFF / ADVANCED	-----N	⊕	L 1
BASIC	-----N	⊕	L 2 L 1
1-10 V	-----N	⊕	L 1 - +
DALI	-----N	⊕	L 1 D D
DMX	-----N	⊕	L 1 - + S

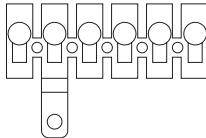

### Notice:

All FLC200 luminaires are vented, and have a venting element. For the FLC230/240/260 the housing contains a M12 venting element (IP68). In the FLC220 the venting element is contained in the main entry gland. Under no circumstances are the glands to be removed from this luminaire. The secondary gland is supplied with a blanking element if not required for cabling, the blanking element retains the rated IP of the luminaire.

For operation as color changer the floodlights of the FLC200-CC series require a DMX control signal. The operation without control signal may lead to error.

The operation of the Wireless DMX version requires the luminaire to be configured to a suitable wireless access point. The luminaire is supplied addressed but unpaired to an access point. All FLC200-CC have RDM compatible drivers



**we-ef**

**www.we-ef.com**

**WE-EF LEUCHTEN**

Germany

Tel +49 5194 909 0

Fax +49 5194 909 299

info.germany@we-ef.com

**WE-EF LUMIERE**

France

Tel +33 4 74 99 14 44

Fax +33 4 74 99 14 40

info.france@we-ef.com

**WE-EF HELVETICA**

Switzerland

Tel +41 22 752 49 94

Fax +41 22 752 49 74

info.switzerland@we-ef.com

**WE-EF LIGHTING**

United Kingdom

Tel +44 844 880 5346

Fax +44 844 880 5347

info.uk@we-ef.com

**WE-EF LIGHTING**

Thailand

Tel +66 2 738 9610

Fax +66 2 175 2174

info.asiapacific@we-ef.com

**WE-EF LIGHTING**

Australia

Tel +61 3 8587 0444

Fax +61 3 8587 0499

info.australia@we-ef.com

**WE-EF LIGHTING**

United States of America

Tel +1 724 742 0030

Fax +1 724 742 0035

info.usa@we-ef.com



FLC200 LED / FLC200-CC LED\_070220 / 006-1348

Technical specifications are subject to change.

© WE-EF 2020

**Liability**

WE-EF LIGHTING accepts no liability when damage is caused by improper use or installation.

If any luminaire and/or accessory is subsequently modified, the persons responsible for the modification shall bare all liability.