

**we-ef**

**WE-EF LIGHTING**

Installation and  
Maintenance Instructions for  
**FLC220 LED Profile Projector**





**WARNING :**

This product to be installed by qualified personnel only.

**Switch off and isolate the electrical supply during installation.**

At no stage is the luminaire to be opened when live.

Connections and cables are labelled, before installation ensure the supply matches the luminaire designation.

**ESD Sensitive Device:**

This luminaire contains electrostatic sensitive devices. Do not handle the LED PCB or LED connection leads without suitable ESD prevention methods in place. If in doubt contact WE-EF LIGHTING or an authorised Sales partner. Warranty can be void if the correct handling procedures are not observed.

**Surge Protection:**

For comprehensive protection of a luminaire installation against lightning and electrical surges, it is essential to cover mains supply and data input lines at the distribution board level, by using respective primary (Type 1) and secondary (Type 2) surge arrestors in compliance with EN61643-11/IEC61643-1.

Luminaires designated with the type code '+A' will have an internal Surge Protection Device (SPD) fitted. Street and area luminaries are supplied with an external SPD.

Where an external SPD is supplied, it must be fitted as per the supplied instructions to maintain warranty conditions.

Ensure that all required surge protection measures are in place and activated prior to luminaire installation. Disconnect luminaires before operating high-power devices such as, for example, electrical arc welders.

**Cleaning:**

Apart from cleaning the product's exterior surfaces, no special maintenance work is required. **DO NOT** use high pressure cleaners on this luminaire

**Notice:**

Unless directed by this installation instruction, the luminaire is to be treated as Factory Sealed with no user serviceable parts. If the luminaire is modified by anybody other than the original manufacturer, the warranty will no longer be valid and shall become the full responsibility of the modifying person/organisation. Claims based on defects attributable to improper installation and/or application, and the consequences thereof, are also excluded.

## Profile Projector

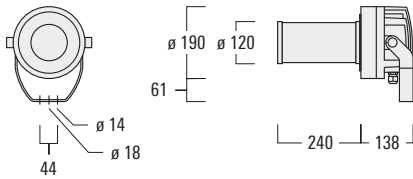

### Light source

LED-FT 37W

IP66, IK06, Class I,  $t_a = 25^\circ\text{C}$

Windage area: .....0,06 m<sup>2</sup>

Weight: ..... 8,2 kg

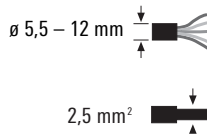

### Gobo diameter

Standard diameter outside 66 mm, inside 48 mm. WE-EF recommends an inside diameter of 38 mm.

### Tools required

- Screwdriver TX 25
- Screwdriver TX 40
- Screwdriver TX 70
- Screwdriver Philips PH2

**Notice:** In case the luminaire is equipped with an optional available surge protector, the function can get tested if the signal LED is lit green when the supply voltage is turned on.

In case the surge protector is defective, the LED device gets automatically disconnected from the mains supply.

If the signal LED is not lit, the luminaire is not functioning.

### Installation

The product must be installed and maintained by a suitably qualified professional in compliance with latest building/ construction and/or electrical regulations and relevant legislation.

In case of component failure due to abnormal circumstances or at end of life, replacement must be carried out by a suitably qualified and trained professional.

In case of questions please contact our technical hotline:+61 458 933 399 (from Monday - Friday from 07.00 until 19.00 hours).

## Maintenance

Apart from cleaning the product's exterior surfaces, no special maintenance work is required. Do not use high-pressure cleaners.

## Adjusting the lenses

The projector must be in operation when the lenses are being adjusted, these adjustments may not be made in the rain, snow or in the event of increased humidity.

**Caution: Do not touch the LED area!**

## Installation Procedure (Mounting and Termination)

- 1) Prior to electrical connection, proceed with mechanical installation by firmly fixing stirrup **A** to optional mounting accessory or directly to a suitable surface.

Aim luminaire.

**Caution:** Make sure not to damage any electric cable, water pipe or other devices while drilling holes.

- 2) Switch off and isolate the mains electrical supply. ⚡
- 3) Remove gear box cover **B** by releasing screws **C**.
- 4) Check that rating shown on the luminaire label conforms with the mains electrical supply.
- 5) Feed mains supply cable **D** through cable gland **E**. An additional M20 gland is supplied to allow loop through of supply cabling or alternative DMX cabling arrangements.
- 6) Connect to the correspondingly marked contacts of terminal **F**, according to the wiring diagram. Tighten cable gland **E** firmly.
- 7) Reposition gear box cover **B** and tighten screws **C** evenly.
- 8) Loosen the two screws **G** slightly. Aim luminaire (see illustration), tighten screws **G** firmly (**100Nm**). In addition, tighten screw **H** (max. **6Nm**) to secure orientation of luminaire.

### Torque

Screw	Torque
TX20	max. 2,0 Nm
TX25	max. 4,0 Nm
TX27	max. 6,0 Nm
TX30	max. 15,0 Nm
TX70	max. 100,0 Nm

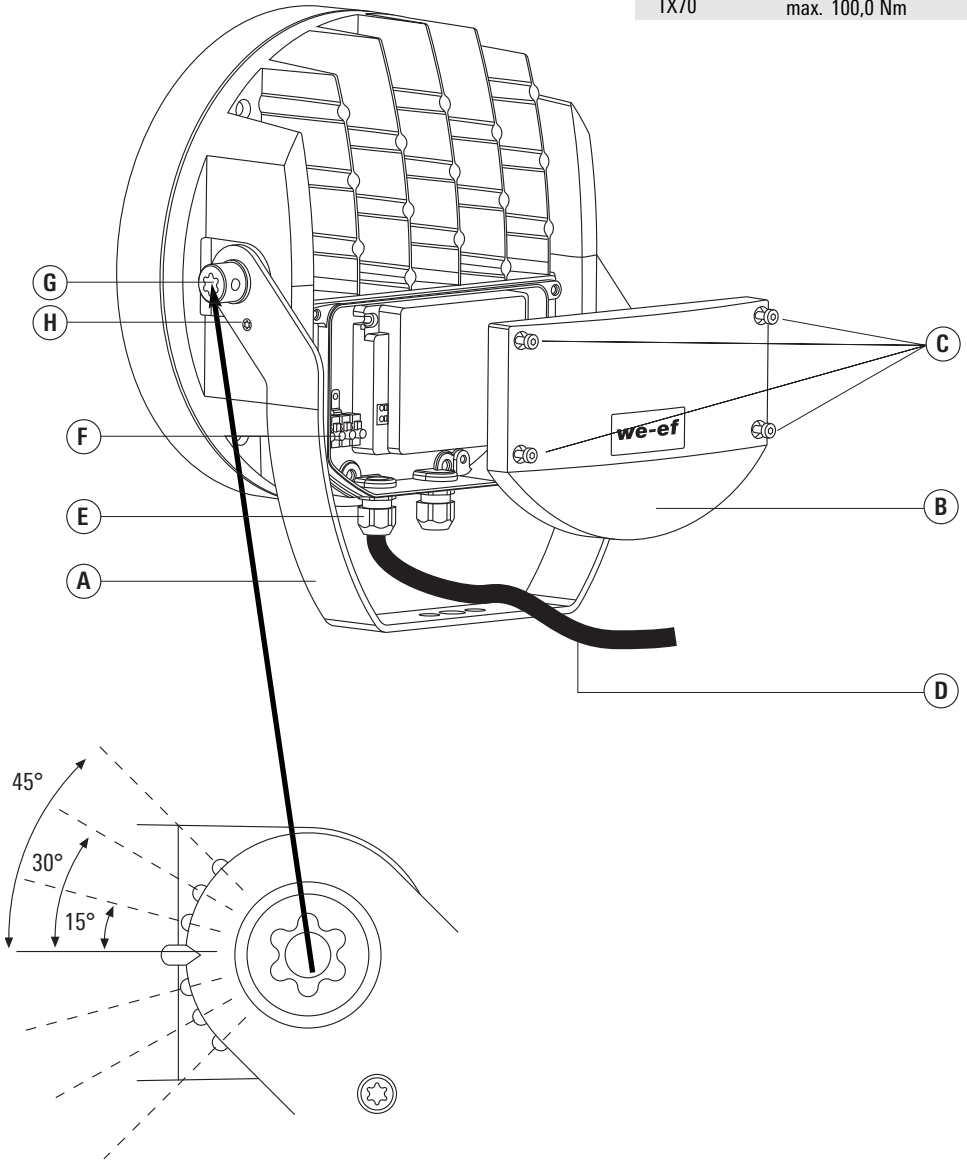

## Wiring Diagram

### WE-EF Advanced, CC Wireless DMX, DALI Casambi and non dimmable luminaires

Class I → Phase to L1, Neutral to N and Earthing to ⊕

For DALI Casambi applications, **4remote BT app** is required to commission or control luminaires, scan QR code to download app to mobile device (iOS or Android required).



Class II → Phase to L1, Neutral to N

### WE-EF Basic

Class I → Phase to L1, Control Phase to L2,  
Neutral to N and Earthing to ⊕

Class II → Phase to L1, Control Phase to L2, Neutral to N

### 1-10V / DALI (INC TW) / CC (DMX)

Class I → Phase to L1, Neutral to N and Earthing to ⊕,  
1-10V, DMX to + and 1-10V, DMX to -  
DALI to D

Class II → Phase to L1, Neutral to N,  
1-10V, DMX to + and 1-10V, DMX to -  
for DMX shield on 'S'  
DALI to D

ON-OFF / ADVANCED	-----N	⊕	L 1
BASIC	-----N	⊕	L 2 L 1
1-10 V	-----N	⊕	L 1 - +
DALI	-----N	⊕	L 1 D D
DMX	-----N	⊕	L 1 - + S

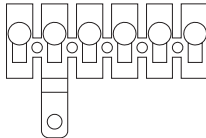

### Notice:

All FLC200 luminaires are vented, and have a venting element. For the FLC230/240/260 the housing contains a M12 venting element (IP68). In the FLC220 the venting element is contained in the main entry gland. Under no circumstances are the glands to be removed from this luminaire. The secondary gland is supplied with a blanking element if not required for cabling, the blanking element retains the rated IP of the luminaire.

## Installation Procedure (Projector)

- 1) Slightly loosen the fasteners **J**; do not remove them.  
Turn the profile **K** to the left and carefully remove it by pulling it towards the front.

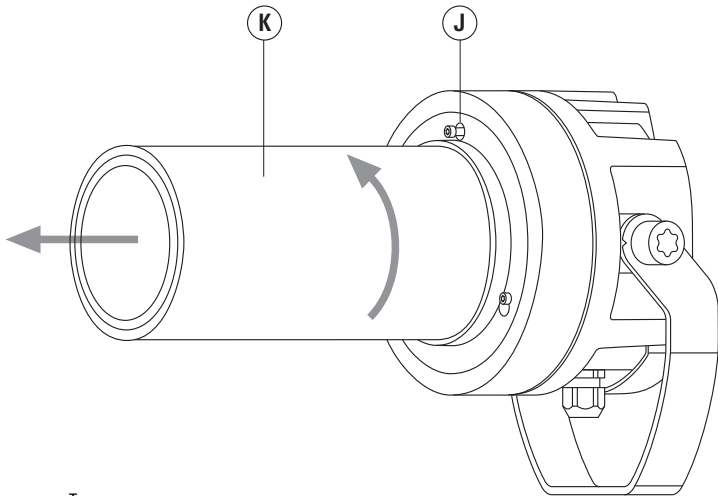

### Torque

Screw	Torque
TX20	max. 2,0 Nm
TX25	max. 4,0 Nm
TX27	max. 6,0 Nm
TX30	max. 15,0 Nm
TX70	max. 100,0 Nm

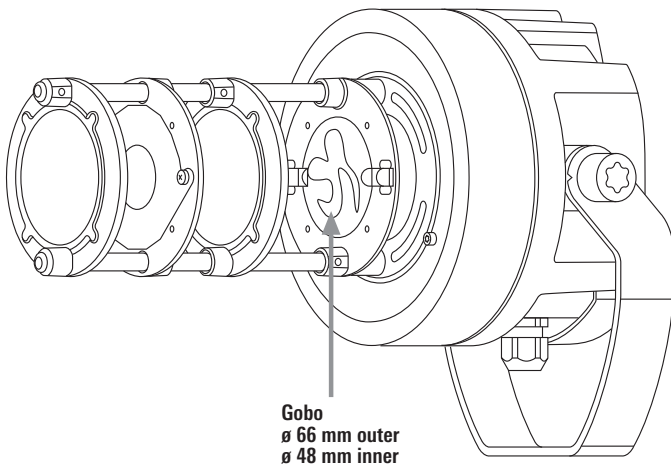



2) The retainer **N** with the desired insert always remains in the position set at the factory.

**Do not change this Position!**

For ZP / FP version **Q** is rotated 180°

- GP version: Holder **Y** with shield ID36.
- The projector is factory set at 10 m distance.

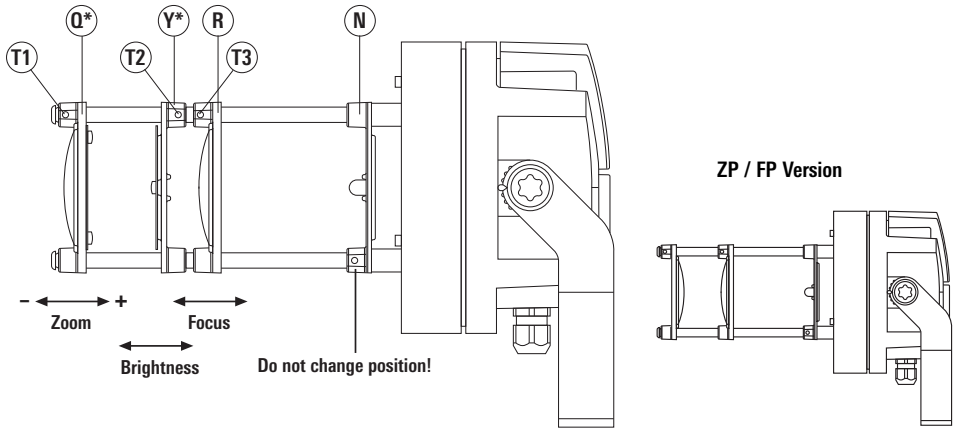

### 2.1) Gobo projector – [GP]

Insert the gobo **M** (motif up to a maximum diameter of 48 mm) into the retainer **N**. To do so, slide the retention springs **P** outwards, insert the gobo **M**, align and slide the retention springs **P** back into place to secure it.

WE-EF recommends an inside diameter of 38 mm for the gobo.

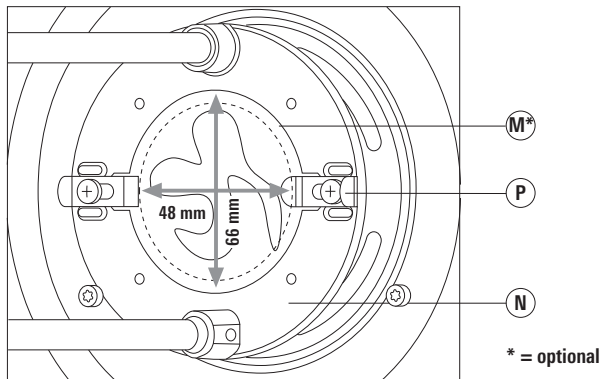

## 2.2) Frame projector – [FP]

The contour of the emitted light may be set with the four shutters **X** by using the contour slide **O** in the retainer **N**. To do so, unscrew the fasteners **W2**, set the desired contour by moving the shutters **X** and tighten the fasteners **W2**.

Frame size in the projector max. 32mm, min. 15mm

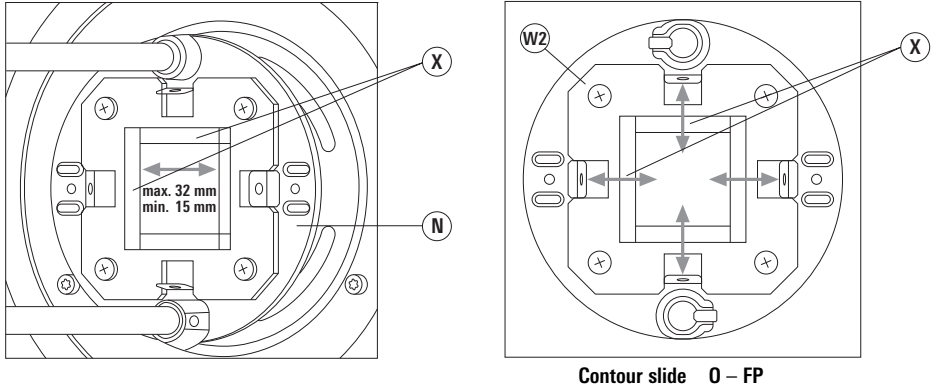

3) To set the image size, loosen the grub screws **T1** on the zoom lens **Q** and move until the desired size has been achieved.

4) To focus, loosen the focus lens **R** with the grub screws **T3** and move until the image is sharply delineated. Tighten all grub screws **T1 / T3** again.

## 5) Only for Gobo projector – [GP]

For adjusting the brightness of the gobo image, loosen the grub screws **T2** of the cover **Y** and set the desired light intensity.

Then tighten the grub screws **T2** again.

6) Clean the lenses with the provided microfibre cloth.

7) Make sure that the luminaire is completely dry inside and all gasket areas are free of dirt. Open the attached aluminium bag and put the bag with the drying agent at a suitable spot at the bottom of the luminaire.

8) Carefully slide the profile **K** over the lens, turn it to the right and secure it with the three fastening fasteners **J** once all the desired settings have been made.



**we-ef**

[www.we-ef.com](http://www.we-ef.com)

**WE-EF LEUCHTEN**

Germany

Tel +49 5194 909 0

Fax +49 5194 909 299

[info.germany@we-ef.com](mailto:info.germany@we-ef.com)

**WE-EF LUMIERE**

France

Tel +33 4 74 99 14 44

Fax +33 4 74 99 14 40

[info.france@we-ef.com](mailto:info.france@we-ef.com)

**WE-EF HELVETICA**

Switzerland

Tel +41 22 752 49 94

Fax +41 22 752 49 74

[info.switzerland@we-ef.com](mailto:info.switzerland@we-ef.com)

**WE-EF LIGHTING**

United Kingdom

Tel +44 844 880 5346

Fax +44 844 880 5347

[info.uk@we-ef.com](mailto:info.uk@we-ef.com)

**WE-EF LIGHTING**

Thailand

Tel +66 2 738 9610

Fax +66 2 175 2174

[info.asiapacific@we-ef.com](mailto:info.asiapacific@we-ef.com)

**WE-EF LIGHTING**

Australia

Tel +61 3 8587 0444

Fax +61 3 8587 0499

[info.australia@we-ef.com](mailto:info.australia@we-ef.com)

**WE-EF LIGHTING**

United States of America

Tel +1 724 742 0030

Fax +1 724 742 0035

[info.usa@we-ef.com](mailto:info.usa@we-ef.com)



FLC220 LED\_PP\_010219 / 006-1541

Technical specifications are subject to change.

© WE-EF 2019

**Safety indices**

The manufacturer is then discharged from liability when damage is caused by improper use or installation.

If any luminaire and/or accessory is subsequently modified, the persons responsible for the modification shall be considered as manufacturer.

The installation on site must comply with local and/or national health and safety regulations.