



WE-EF LIGHTING

Installation and
Maintenance Instructions for
Catenary mounted luminaires
RFS500 LED Series

A circular graphic with a yellow top half and a black bottom half. The 'we-ef' logo is in the top left of the yellow section. The text 'INSTALLER HOTLINE' is in the center of the yellow section, next to a smartphone icon. The phone number '+61 458 933 399' and the hours '7am - 7pm AEST' are in the black section.

we-ef
**INSTALLER
HOTLINE** 
+61 458 933 399
7am - 7pm AEST

This page intentionally left blank

**WARNING :**

This product to be installed by qualified personnel only.

Switch off and isolate the electrical supply during installation.

At no stage is the luminaire to be opened when live. Connections and cables are labelled, before installation ensure the supply matches the luminaire designation.

**ESD Sensitive Device:**

This luminaire contains electrostatic sensitive devices. Do not handle the LED PCB or LED connection leads without suitable ESD prevention methods in place. If in doubt contact WE-EF LIGHTING or an authorised Sales partner. Warranty can be void if the correct handling procedures are not observed.

**Surge Protection:**

For comprehensive protection of a luminaire installation against lightning and electrical surges, it is essential to cover mains supply and data input lines at the distribution board level, by using respective primary (Type 1) and secondary (Type 2) surge arrestors in compliance with EN61643-11/IEC61643-1.

Luminaires designated with the type code '+A' will have an internal Surge Protection Device (SPD) fitted. Street and area luminaries are supplied with an external SPD.

Where an external SPD is supplied, it must be fitted as per the supplied instructions to maintain warranty conditions.

Ensure that all required surge protection measures are in place and activated prior to luminaire installation. Disconnect luminaires before operating high-power devices such as, for example, electrical arc welders.

**Cleaning:**

Apart from cleaning the product's exterior surfaces, no special maintenance work is required.

DO NOT use high pressure cleaners on this luminaire

**Notice:**

Unless directed by this installation instruction, the luminaire is to be treated as Factory Sealed with no user serviceable parts. If the luminaire is modified by anybody other than the original manufacturer, the warranty will no longer be valid and shall become the full responsibility of the modifying person/organisation. Claims based on defects attributable to improper installation and/or application, and the consequences thereof, are also excluded.

If the supplied cable of the luminaire is damaged, it must be replaced by WE-EF or a WE-EF authorized agent.

Catenary mounted luminaires

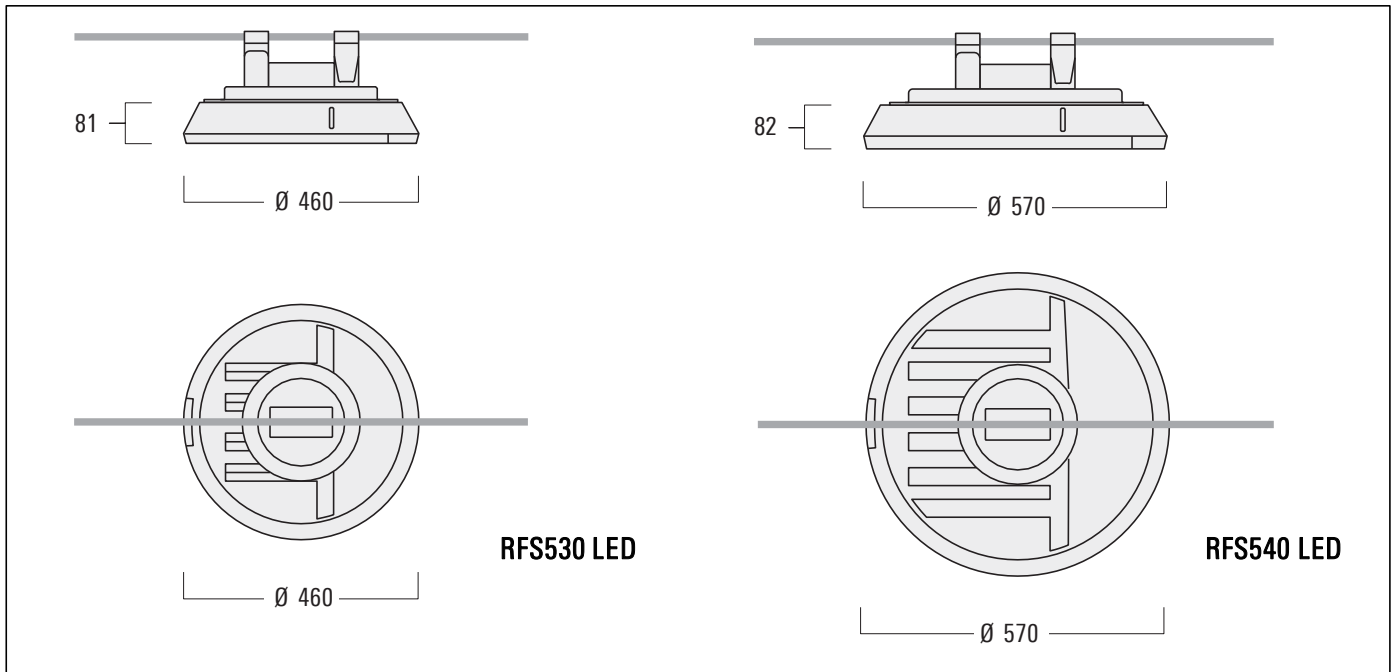

Lamps

RFS530

12 LED 12W / 24 LED 24W*

12 LED 24W / 24 LED 48W*

RFS540

36 LED 36W / 48 LED 48W*

36 LED 72W / 48 LED 96W*

* Nominal power, for latest data refer to www.we-ef.com

Protection: IP66, IK08

Class I, II, ta = 25°C

Weight: RFS530 max. 10,0 kg
RFS540 max. 14,0 kg

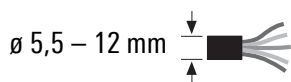

Windage area:

RFS530 0,062 m²

RFS540 0,074 m²

Mounting height: 3-8 m

Installation: horizontal, light output downwards

Catenary suspension, wire dia: 6-12 mm

Catenary suspension, wire angle adjustment (incline): max. 10°

Possible twisting/rotation to wire: ± 25°

Tools required

- 4 mm / 6 mm Allen key
- Box spanner SW 13 mm
- open-ended spanner SW 24 mm

Installation Procedure

- 1) Switch off and isolate the mains electrical supply **A**.
- 2) Loosen screws of wire mounting suspension clamps **B** (**fig.2**).
- 3) Hang luminaire with wire mounting suspension clamps to the wire.
- 4) Tighten screws of clamps **B**.
- 5) In case the luminaire is not to be angled horizontally, the wire mounting suspension can get adjusted to inclinations. To do this loosen the screws **P** of the clamps, adjust luminaire and tighten screws again (**fig.1**).
- 6) Loosen screws **E** on cover **F** of the wire mounting suspension and remove the cover (**fig. 2**).
- 7) Insert the corresponding wire length cut to suit connecting line **A**, through the cable gland **H** inside the connecting box **G** (**fig.2**). For optional through wiring there is an additional cable gland **H** equipped with a plug which can be removed if required.
- 8) Connect cable to the corresponding marked contacts of the terminal clamp. Compare local voltage and frequency with the data shown on luminaire label.
For class II applications the earth protection is not applicable. All leads and connections must match class II standards. Use the strain relief.
- 9) Firmly tighten cable gland **H** and reposition cover **E** onto the connecting box **G** and tighten it.
- 10) The luminaire can get adjusted up to 25° to each side, to illuminate an object (**fig.3**). For this, loosen the screws **Q** and the cable gland **I**. Pull out the connecting line, which runs from the wire mounting suspension inside the luminaire, as much as required.
When luminaire is adjusted, firmly tighten screws **Q** and the cable gland.

fig. 1

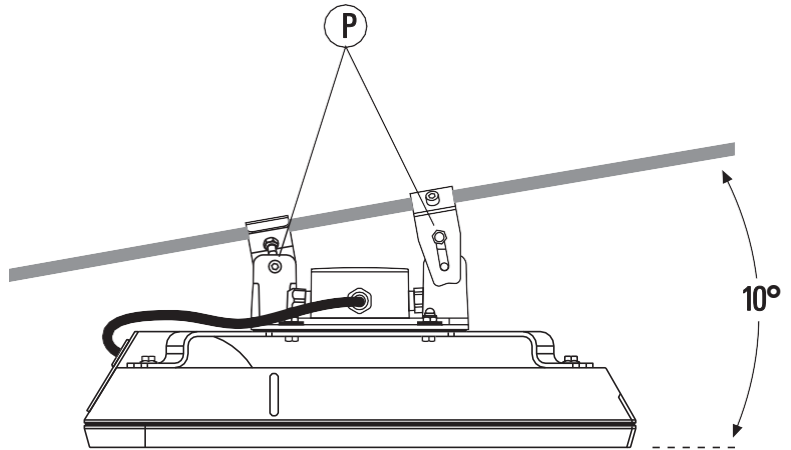

Screw	Torque
M4	max. 2,0 Nm
M5	max. 4,0 Nm
M6	max. 6,0 Nm
M8	max. 15,0 Nm
M16	max. 100,0 Nm

fig. 2

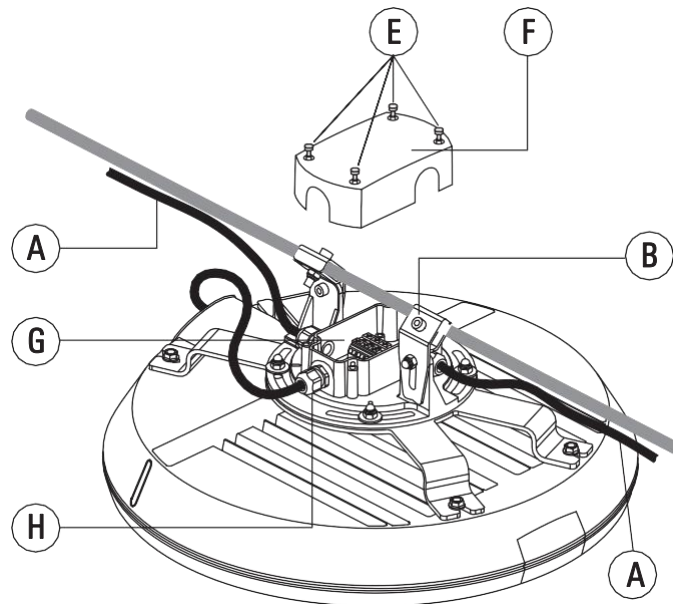
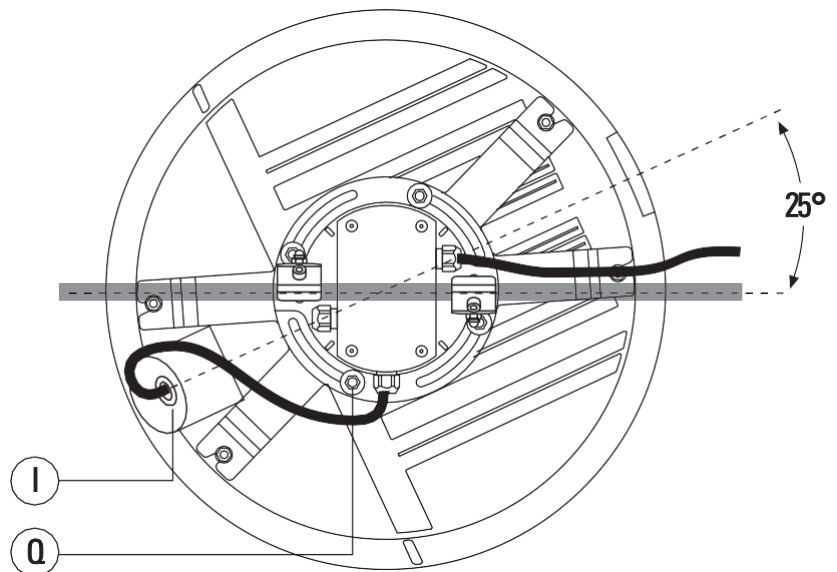

fig. 3



This page intentionally left blank

we-ef

www.we-ef.com

WE-EFLIGHTING

Australia

Tel +61 3 8587 0444

Fax +61 3 8587 0499

info.australia@we-ef.com

WE-EFLIGHTING

Thailand

Tel +66 2 7389610

Fax +66 2 1752174

info.asiapacific@we-ef.com

WE-EFLEUCHTEN

Germany

Tel +49 5194 9090

Fax +49 5194 909299

info.germany@we-ef.com

WE-EFLIGHTING

United States of America

Tel +1 724 742 0030

Fax +1 724 742 0035

info.usa@we-ef.com

WE-EFLUMIERE

France

Tel +33 4 74 99 14 44

Fax +33 4 74 99 14 40

info.france@we-ef.com

WE-EFHELVETICA

Switzerland

Tel +41 22 752 4994

Fax +41 22 752 4974

info.switzerland@we-ef.com

WE-EFLIGHTING

United Kingdom

Tel +44 844 880 5346

Fax +44 844 880 5347

info.uk@we-ef.com



RFS500LED_020519.

Technical specifications are subject to change.

© WE-EF2019