

we-ef



WE-EF LEUCHTEN

Installation and
Maintenance Instructions for
Linear Wallwasher
VLR100 LEDSeries



Factory Sealed

The LED head of this product is factory sealed, only the base requires installation. Refer to the instructions contained in this document for details.



Surge Protection

For comprehensive protection of a luminaire installation against lightning and electrical surges, it is essential to cover mains supply and data input lines at the distribution board level, by using respective primary (Type 1) and secondary (Type 2) surge arrestors in compliance with EN61643-11/ IEC61643-1.

Warning

Ensure that all required surge protection measures are in place and activated prior to luminaire installation. Also, disconnect luminaires before operating high-power devices such as, for example, electrical arc welders.

Linear Wallwasher

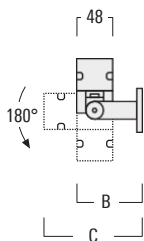
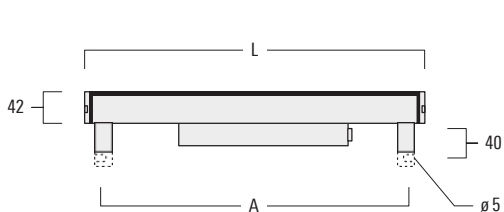

Version LA

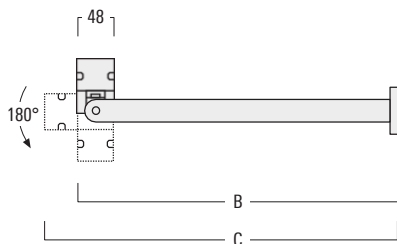
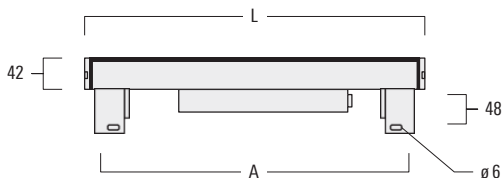

Lamps

Medium Wattage LEDs WE-EF, 3 Step McAdams, CRI ≥80

Power: 7,5 - 37,5W

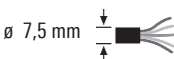

Protection IP67 / IK04

(due to the materials used these luminaires are not suitable for durable underwater use)

Class I

Weight: 1,2 - 4,8 kg

Tools required

– 3 mm and 5 mm Allen keys

Installation

The product must be installed and maintained by a suitably qualified professional in compliance with latest building/ construction and/or electrical regulations and relevant legislation.

Warning: Switch off mains electrical supply prior to installing and connecting the luminaire. Do not open luminaire while mains supply is switched on.

Notice: If the luminaire is modified by anybody other than the original manufacturer, then the warranty will no longer be valid and shall become the full responsibility of the modifying person/organisation. Claims based on defects attributable to improper installation and/or application, and the consequences thereof, are excluded.

In case of component failure, LED replacement due to abnormal circumstances or at end of life, replacement must be carried out by a suitably qualified and trained professional.

In case of questions please contact our technical hotline: +61 8587 0444 (from Monday - Friday from 08.00 until 16.00 hours.

Maintenance

Apart from cleaning the product's exterior surfaces, no special maintenance work is required.

Do not use high pressure cleaners.

Table 1

Typ	L	A	B	C
VLR 110	328	287	88	132
VLR 120	628	587	88	132
VLR 130	928	887	88	132
VLR 140	1228	1187	88	132
VLR 150	1528	1487	88	132
VLR 120 LA	628	578	424	468
VLR 130 LA	928	878	424	468
VLR 140 LA	1228	1178	424	468

Installation Procedure

Luminaire is factory sealed and does not need to be opened during installation.

- 1) Switch off the mains electrical supply.
- 2) Determine position of the fixing screws D (not included). Check table 1 about the distance of the drilling holes. Drill corresponding fixing holes and insert dowel E (not included, if required, choose suitable fixing material). Attention: Make sure not to damage any electrical cable, water pipes or other devices.

VLR120/130/140/150 Integral

Incoming Supply Cores
Core 1 = Active
Core 2 = Neutral
Core 3 = DALI
Core 4 = DALI
G/Y = Earth

VLR110 Remote

Incoming Supply Cores Core
1 = Active
Core 2 = Neutral
Core 3 = DALI/1-10+
Core 4 = DALI/1-10-
G/Y = Earth

- 3) Install wall brackets B to luminaire A and fix, applying 2Nm of torque by use of the screws G.
- 4) Affix the luminaire A to the mounting surface by use of the screws D.
- 5) Connect cable C:
 - a) for the remote version (VLR110) the cable C of the gearbox F is connected to the mains supply in accordance with labelled cables. **Note: Size and shape of gearbox F may vary according to control version (DALI or 1-10V)**
 - b) for the integral version the cable C of the luminaire is connected to the mains supply in accordance with labelled cables.
- 6) After the luminaire A is connected, the bracket can be adjusted by loosening and respectively tightening screws G.
- 7) Remove foil from the lens before use.

VLR110 Remote

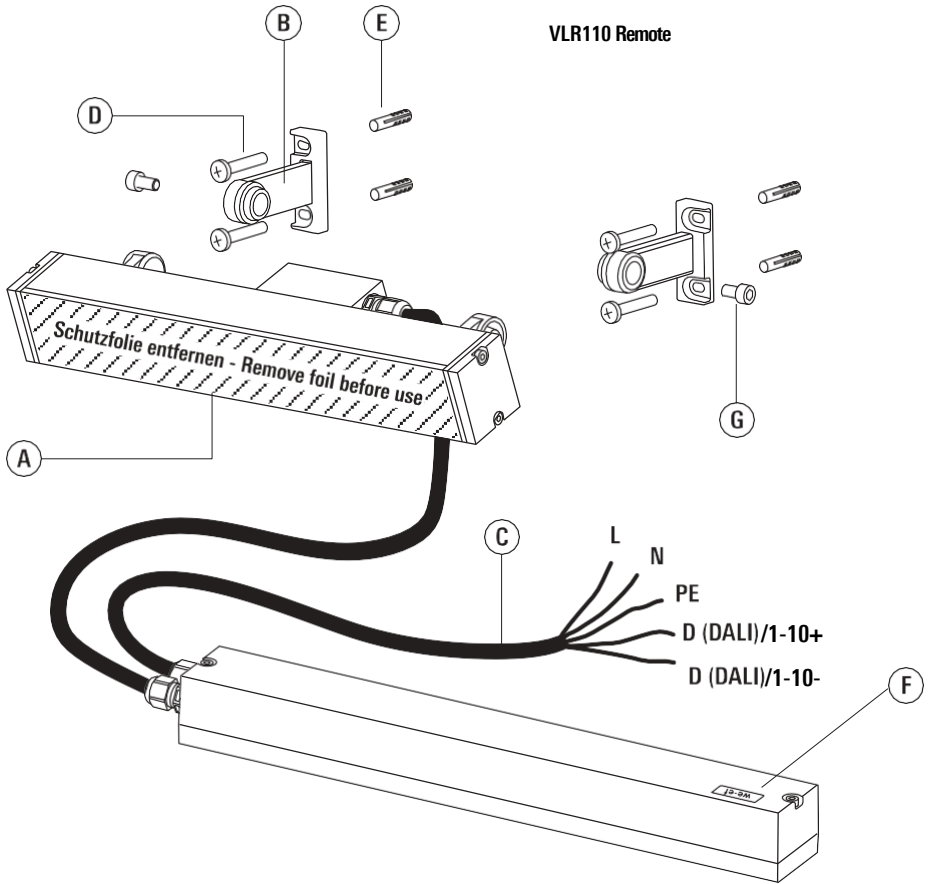

VLR120/130/140/150 Integral

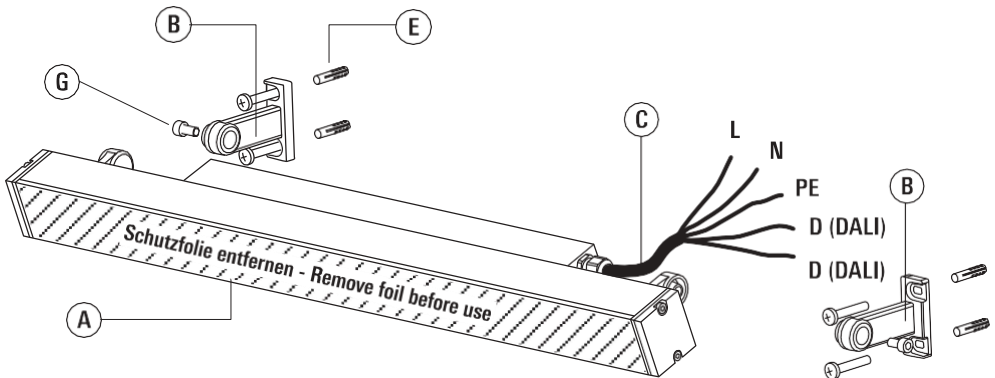

we-ef

www.we-ef.com

WE-EF LEUCHTEN

Germany

Tel +49 5194 909 0

Fax +49 5194 909 299

info.germany@we-ef.com

WE-EF LUMIERE

France

Tel +33 4 74 99 1444

Fax +33 4 74 99 14 40

info.france@we-ef.com

WE-EF HELVETICA

Switzerland

Tel +41 22 752 4994

Fax +41 22 752 49 74

info.switzerland@we-ef.com

WE-EF LIGHTING

United Kingdom

Tel +44 844 880 5346

Fax +44 844 880 5347

info.uk@we-ef.com

WE-EF LIGHTING

Thailand

Tel +66 2 738 9610

Fax +66 2 175 2174

info.asiapacific@we-ef.com

WE-EF LIGHTING

Australia

Tel +61 3 8587 0444

Fax +61 3 8587 0499

info.australia@we-ef.com

WE-EF LIGHTING

United States of America

Tel +1 724 742 0030

Fax +1 724 742 0035

info.usa@we-ef.com



VLR100_LED_010416 / 006-1294-AU

Technische Änderungen vorbehalten.

Technical specifications are subject to change.

© WE-EF 2016

Safety Information

The manufacturer is then discharged from liability when damage is caused by improper use or installation.

If any luminaire and/or accessory is subsequently modified, the persons responsible for the modification shall be considered as manufacturer.