



WE-EF LEUCHTEN

Installation and Maintenance Instructions

Projector

FLD121 #1 LED

FLD131 #1 LED



Do not open during installation

This product is factory-sealed.
Refer to the instructions contained in this document for details.



Surge Protection

This product features built-in surge protection circuitry in compliance with applicable standards.

For comprehensive protection of a luminaire installation against lightning and electrical surges, it is essential to cover mains supply and data input lines at the distribution board level, by using respective primary (Type 1) and secondary (Type 2) surge arrestors in compliance with EN61643-11/ IEC61643-1.

Warning

Ensure that all required surge protection measures are in place and activated prior to luminaire installation. Also, disconnect luminaires before operating high-power devices such as, for example, electrical arc welders.

Projector

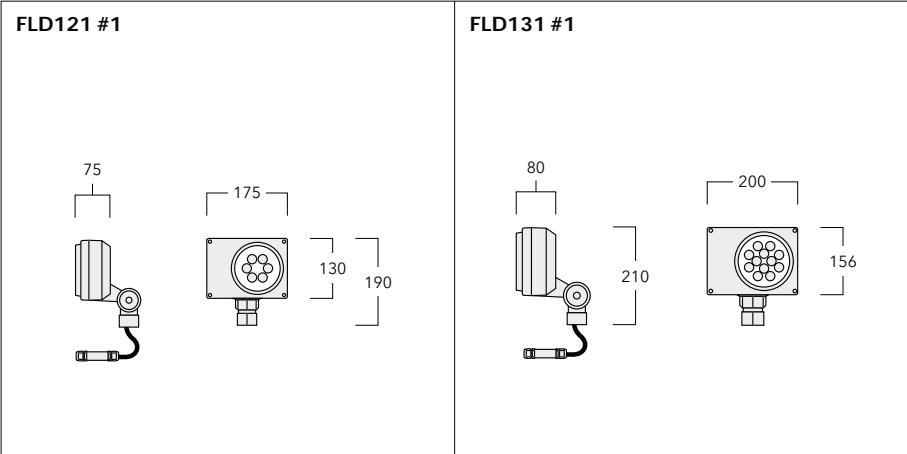

IP66, Class I, ta = 40°C

Mounting Accessories

Flat surface fitter		
SF-FLD1	for FLD121/131 #1	145-9535
Column fitter		
CF-FLD1	for FLD121/131 #1	145-9536

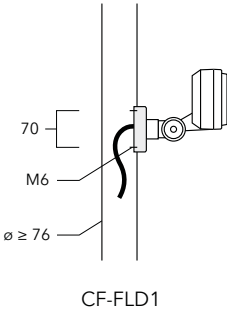
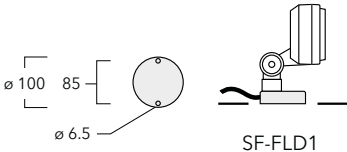

Light Source

LED

Maintenance

Apart from cleaning the product's exterior surfaces, no special maintenance work is required.

Do not use high-pressure cleaners.

In case of component failure due to abnormal circumstances or at end of life, replacement must be carried out by a suitably qualified and trained professional.

Warning: Do not open luminaire while mains supply is switched on.

Installation

The product must be installed and maintained by a suitably qualified professional in compliance with latest building/construction and/or electrical regulations and relevant legislation.

Warning: Switch off mains electrical supply prior to installing and connecting the luminaire.

Notice: If the luminaire is modified by anybody other than the original manufacturer, then the warranty will no longer be valid and shall become the full responsibility of the modifying person/organisation. Claims based on defects attributable to improper installation and/or application, and the consequences thereof, are excluded.

The installation on site must comply with local and/or national health and safety regulations.

Installation Procedure

Installation - Flat surface fitter

- 1) Switch off mains electrical supply.

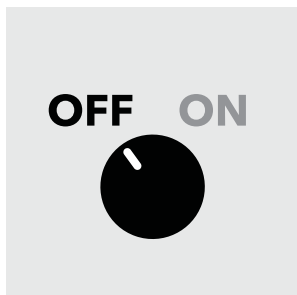

- 2) Detach strain relief clip **K** from flat surface fitter **T**.

Attention: Keep strain relief clip **K** for locking cable later (in step 5).

Feed cable **C** from luminaire **A** through pivot **I** and hole **L** of flat surface fitter **T**.

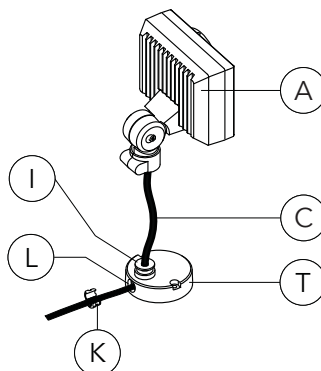

- 3) Determine positions for fixing screws **D**.
Drill relevant holes **Q** and insert nylon plugs **R**.
Insert and tighten screws **D**.

Warning: Ensure not to damage any electrical cable, water pipe or other items drilling holes.

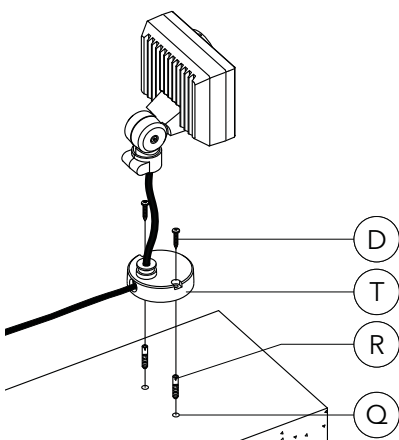

- 4) Loosen screw **M** on slipfitter **H** (do not turn it out) until slipfitter can be opened. Connect luminaire **A** with flat surface fitter **T** by sliding slipfitter **H** over pivot **I**, while pulling luminaire **A** towards object to be illuminated. Ensure slipfitter **H** is properly seated on pivot **I**, then tighten screw **M**.

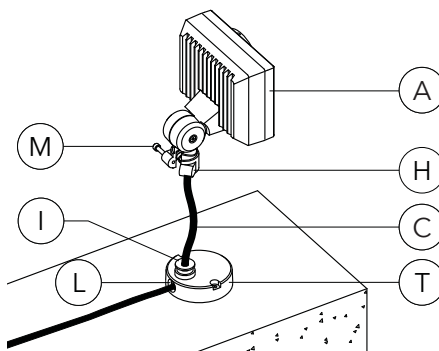

- 5) Clamp strain relief clip **K** on cable **C** and press into hole **L** of flat surface fitter **T**. Ensure the strain relief clip **K** is properly placed in position to lock the cable.

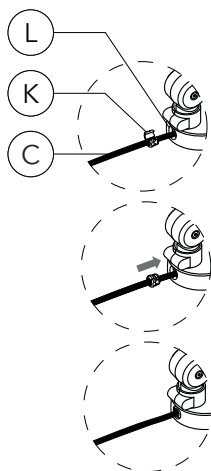

- 6) Check that rating shown on luminaire label conforms with mains electrical supply.

we-ef

04/19 IP66 **CE**

FLC121-LED → 220-240V50-60/Hz

145-XXXX

SOE XXXXXXXX

LED 3000K 12W item no. XXX

(example)

- 7) Connect leads of luminaire cable **C** and main supply cable **G** to respective terminals of socket **S** in connecting box **J**:

a) ON/OFF (L = Phase, N = Neutral,

⊕ = Earthing)

b) 1-10 V/DALI (L = Phase, N = Neutral,

⊕ = Earthing, DA/DA = DALI control line,

D-/D+ = 1-10 V control line).

Attention: Ensure connecting box is firmly tightened for proper sealing.

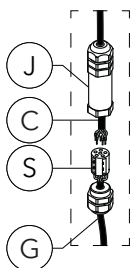

- 8) Loosen screws **N** and **O** slightly. Then aim luminaire in desired direction and tighten screws **N** and **O**.

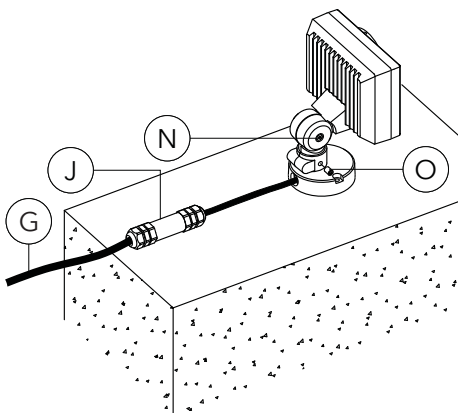

Installation Procedure

Installation - Column fitter

Suitable for column diameter ≥ 76 mm. Service door on column has to be provided for cable termination (maximum 1.5 m from column fitter mounting position).

- 1) Switch off mains electrical supply.

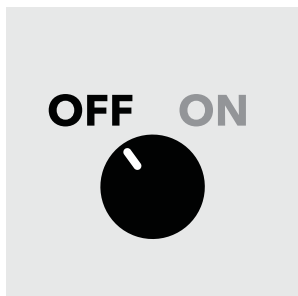

- 2) Determine position for fixing screws **D** and cable entry hole **F**. Drill relevant holes **E** and **F** on column **X**. Ensure cable entry hole **F** has sufficient diameter to feed cable from luminaire.

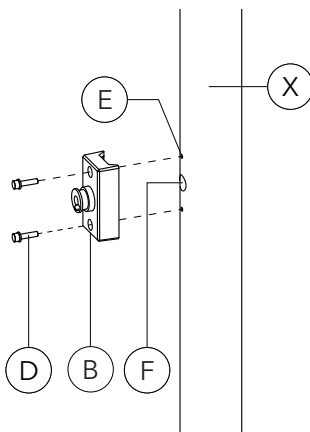

- 3) Set and fix column fitter **B** in position.
Insert and tighten screws **D**.

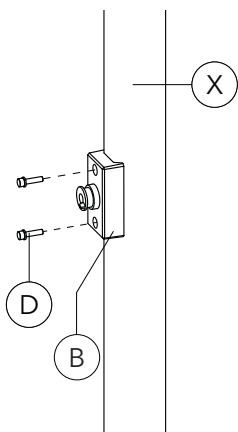

- 4) Loosen screws **M** on slipfitter **H** (do not turn out) until the slipfitter can be opened.

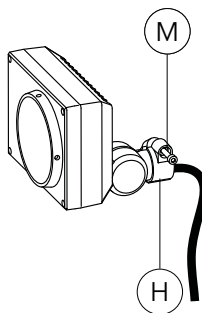

- 5) Feed cable **C** from luminaire **A** through pivot **I** on column **X**, while connecting luminaire **A** with column fitter **B** by sliding slipfitter **H** over pivot **I**. Turn luminaire **A** towards object to be illuminated. Ensure slipfitter **H** is properly seated on pivot **I**, then tighten screw **M**.

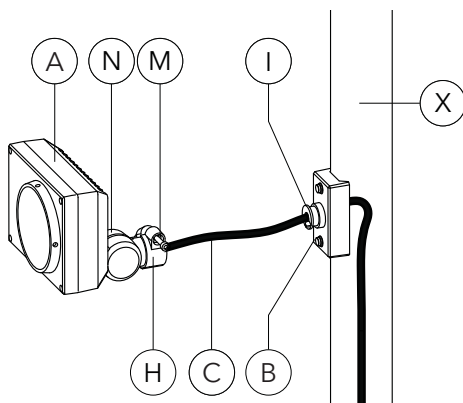

- 6) Check that rating shown on luminaire label conforms with mains electrical supply.

we-ef

04/19 IP66 **CE**

FLC121-LED → 220-240V50-60/Hz

145-XXXX

SOE XXXXXXXX

LED 3000K 12W item no. XXX

(example)

- 7) Connect leads of luminaire cable **C** and main supply cable **G** to respective terminals of socket **S** in connecting box **J**:

- a) ON/OFF (L = Phase, N = Neutral, ⊕ = Earthing)
b) 1-10 V/DALI (L = Phase, N = Neutral, ⊕ = Earthing, DA/DA = DALI control line, D-/D+ = 1-10 V control line).

Attention: Ensure connecting box is firmly tightened for proper sealing.

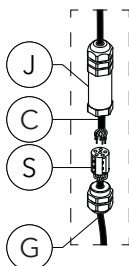

- 8) Loosen screws **N** and **O** slightly. Then aim luminaire in desired direction and tighten screws **N** and **O**.

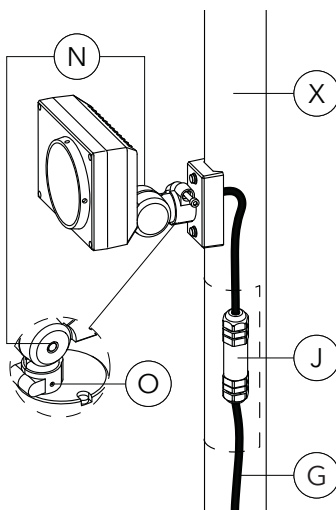



www.we-ef.com

WE-EF LEUCHTEN

Germany

Tel +49 5194 909 0

Fax +49 5194 909 299

info.germany@we-ef.com

WE-EF LUMIERE

France

Tel +33 4 74 99 14 44

Fax +33 4 74 99 14 40

info.france@we-ef.com

WE-EF SWITZERLAND

Switzerland

Tel +41 22 752 49 94

Fax +41 22 752 49 74

info.switzerland@we-ef.com

WE-EF LIGHTING

Thailand

Tel +66 2 738 9610

Fax +66 2 175 2174

info.asiapacific@we-ef.com

WE-EF LIGHTING

Australia

Tel +61 3 8587 0444

Fax +61 3 8587 0499

info.australia@we-ef.com

WE-EF LIGHTING

United States of America

Tel +1 724 742 0030

Fax +1 724 742 0035

info.usa@we-ef.com

TO9210W0823 © WE-EF 2023

Technical specifications are
subject to change.

WE-EF LEUCHTEN

Installation and Maintenance
Instructions

Accessories

Flat surface fitter
Ground Spike
Column fitter
Junction box



Do not open during installation

This product is factory-sealed.
Refer to the instructions contained
in this document for details.



Surge Protection

This product features built-in surge protection circuitry in compliance
with applicable standards.

For comprehensive protection of a luminaire installation against lightning
and electrical surges, it is essential to cover mains supply and data input
lines at the distribution board level, by using respective primary (Type 1)
and secondary (Type 2) surge arrestors in compliance with EN61643-11/
IEC61643-1.

Warning

Ensure that all required surge protection measures are in place and
activated prior to luminaire installation. Also, disconnect luminaires
before operating high-power devices such as, for example, electrical
arc welders.

Accessories

Suitability

- 1. FLB100 Spigot mounted
- 2. FLC300 Spigot mounted
- 3. FLD100 Spigot mounted

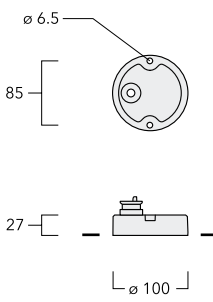
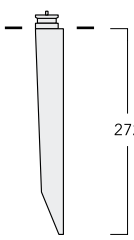
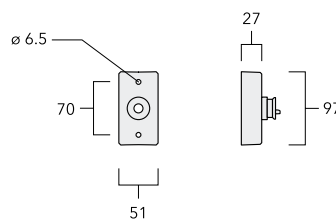
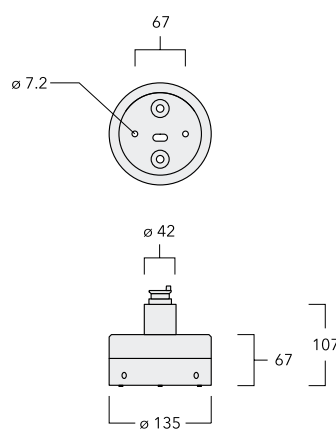
<p>Flat surface fitter 145-9535</p> 	<p>Ground spike 310-9102</p> 
<p>Column fitter 145-9536</p> 	<p>Junction box (Side entry - cable) 310-9002 Junction box (Side entry - conduit) 310-9022 Junction box (Wall entry) 310-9025</p> 

Installation

The product must be installed and maintained by a suitably qualified professional in compliance with latest building/construction and/or electrical regulations and relevant legislation.

Warning: Switch off mains electrical supply prior to installing and connecting the luminaire.

Notice: If the luminaire is modified by anybody other than the original manufacturer, then the warranty will no longer be valid and shall become the full responsibility of the modifying person/organisation. Claims based on defects attributable to improper installation and/or application, and the consequences thereof, are excluded.

Installation instruction of each luminaire will be separated document.

The installation on site must comply with local and/or national health and safety regulations.

Installation Procedure

Flat surface fitter

- 1) Feed cable from luminaire through pivot and cable gland of flat surface fitter **A**.

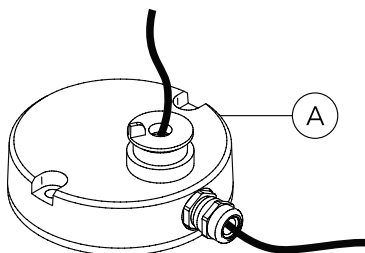

- 2) Determine position for fixing screws **D***.
Drill relevant holes **E** and insert nylon plugs **R***.
Insert and tighten screws **D**. After installation of luminaire, tighten cable gland.

Warning: Ensure not to damage any electrical cable, water pipe or other items drilling holes.

* Not supplied by WE-EF

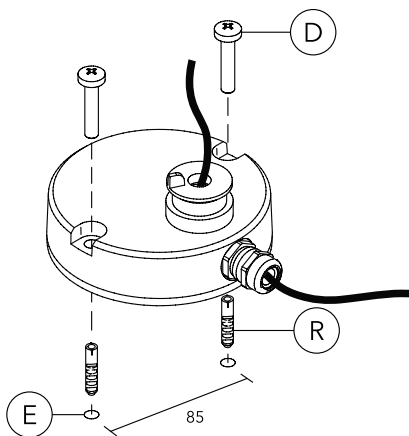

Column fitter

- 1) Drill screw holes **A** and cable entry hole **B** in column. Ensure cable entry hole **B** has sufficient diameter to feed cable from luminaire.

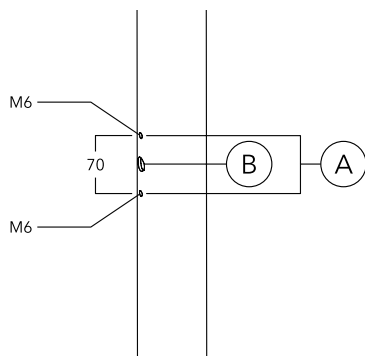

- 2) Set and fix column fitter **C** in position.
Insert and tighten screws **D**.

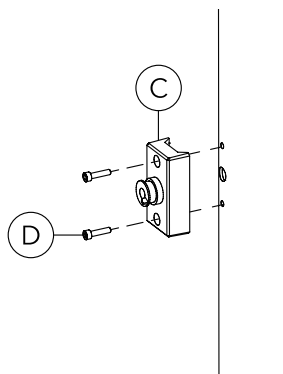

Ground Spike

- 1) **Note:** It is the responsibility to installer to ensure the suitability of the ground spike for site-specific conditions.

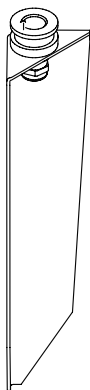

- 2) Place ground spike **H** into the ground.

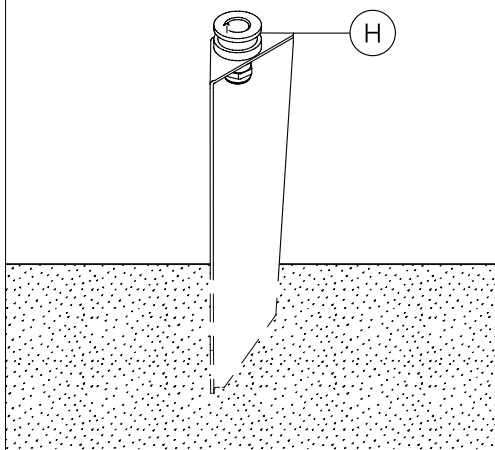

- 3) Feed cable from luminaire through pivot and cable gland **I**. After installation of luminaire, tighten cable gland **I**.

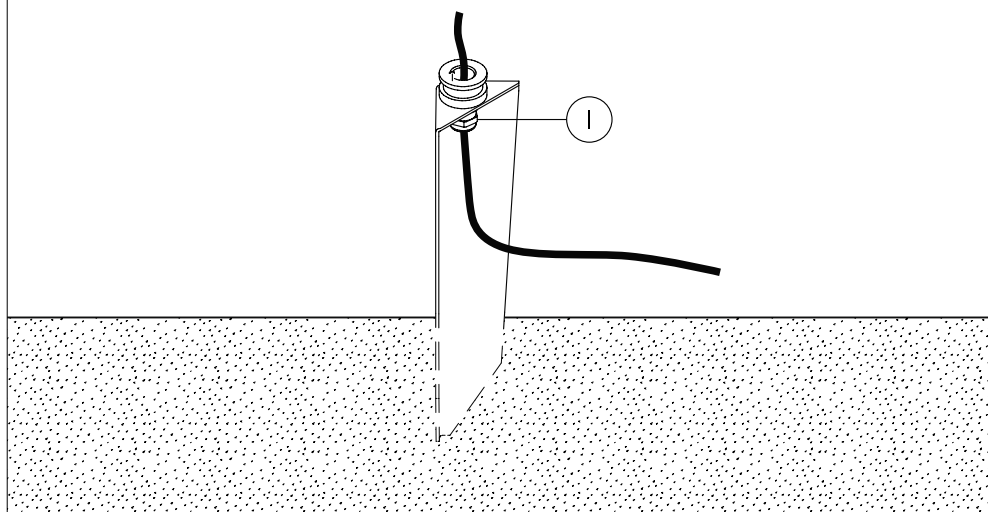

Junction box

- 1) Loosen screws **K** and remove cover **L** from body **M**.

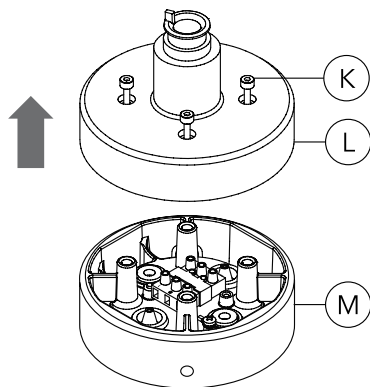

- 2) Feed main supply cable **R** through wall entry or side entry of body **M**.

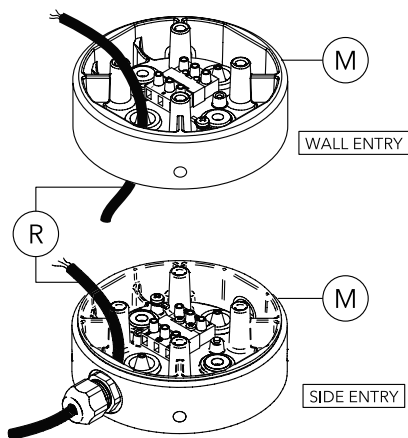

For side entry installations, replace the pre-installed plugs with provided cable glands as required.

- 3) Determine position for fixing screws **N***. Drill relevant holes **O** and insert nylon plugs **P***. Insert screws **N** with washers **Q** and tighten.

Warning: Ensure not to damage any electrical cable, water pipe or other items drilling holes.

* Not supplied by WE-EF

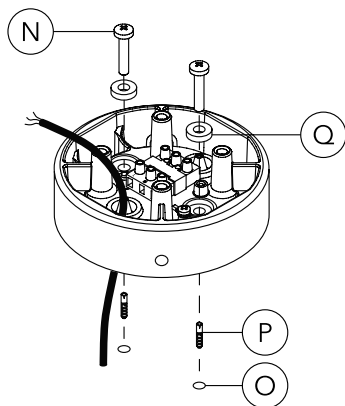

- 4) Feed cable **S** from luminaire through pivot of cover **L**. Connect cable **R** and **S** to terminal block **T** according to wiring shown in separate luminaire installation instruction.

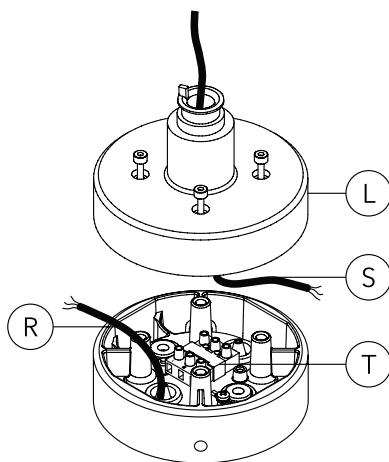

5) After installation of luminaire, place cover **L** on body **M** and tighten screws **K**.

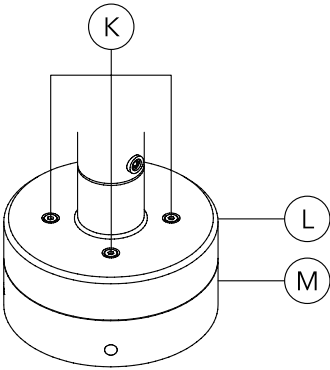



www.we-ef.com

WE-EF LEUCHTEN

Germany

Tel +49 5194 909 0

Fax +49 5194 909 299

info.germany@we-ef.com

WE-EF LUMIERE

France

Tel +33 4 74 99 14 44

Fax +33 4 74 99 14 40

info.france@we-ef.com

WE-EF SWITZERLAND

Switzerland

Tel +41 22 752 49 94

Fax +41 22 752 49 74

info.switzerland@we-ef.com

WE-EF LIGHTING

Thailand

Tel +66 2 738 9610

Fax +66 2 175 2174

info.asiapacific@we-ef.com

WE-EF LIGHTING

Australia

Tel +61 3 8587 0444

Fax +61 3 8587 0499

info.australia@we-ef.com

WE-EF LIGHTING

United States of America

Tel +1 724 742 0030

Fax +1 724 742 0035

info.usa@we-ef.com

TO9253W1124 © WE-EF 2024

Technical specifications are
subject to change.