



WE-EF LEUCHTEN
Installation and Maintenance
Instructions

Projector
FLD111 #3 LED



Do not open during installation

This product is factory-sealed.
Refer to the instructions contained in this document for details.



Surge Protection

This product features built-in surge protection circuitry in compliance with applicable standards.

For comprehensive protection of a luminaire installation against lightning and electrical surges, it is essential to cover mains supply and data input lines at the distribution board level, by using respective primary (Type 1) and secondary (Type 2) surge arrestors in compliance with EN61643-11/ IEC61643-1.

Warning

Ensure that all required surge protection measures are in place and activated prior to luminaire installation. Also, disconnect luminaires before operating high-power devices such as, for example, electrical arc welders.

Projector

FLD111 #3

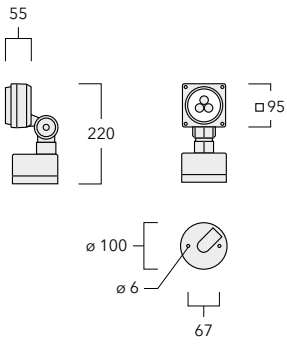

IP66, Class I, $t_a = 40^\circ\text{C}$

Light Source

LED

Maintenance

Apart from cleaning the product's exterior surfaces, no special maintenance work is required.

Do not use high-pressure cleaners.

In case of component failure due to abnormal circumstances or at end of life, replacement must be carried out by a suitably qualified and trained professional.

Warning: Do not open luminaire while mains supply is switched on.

Installation

The product must be installed and maintained by a suitably qualified professional in compliance with latest building/construction and/or electrical regulations and relevant legislation.

Warning: Switch off mains electrical supply prior to installing and connecting the luminaire.

Notice: If the luminaire is modified by anybody other than the original manufacturer, then the warranty will no longer be valid and shall become the full responsibility of the modifying person/organisation. Claims based on defects attributable to improper installation and/or application, and the consequences thereof, are excluded.

Attention: The housing **L** containing the LED light source is factory-sealed and does not need to be opened during installation.

The installation on site must comply with local and/or national health and safety regulations.

Important: When mounting luminaires on concrete or surfaces containing limestone content, WE-EF recommends using mounting accessories - a short post or a ground spike to prevent galvanic corrosion. In areas where mounting accessories are not applicable, ensure the luminaire's aluminium base is separated from concrete and limestone using a plastic or rubber sheet. Allow concrete to cure before installation - DO NOT INSTALL ON WET CONCRETE!

Handling: Ensure the mounting flange plates are handled with care, scratches and damage to the coated surface can result in galvanic corrosion.

A WE-EF warranty does not cover any adverse reaction or damage, due to improper installation and requests that our recommendations are followed.

Installation Procedure

- 1) Switch off mains electrical supply.
- 2) Remove mounting flange **A** by loosening screws **B**. Detach terminal connector **C**.
- 3) Determine position for fixing screws **D**. Drill relevant holes **E** and insert wall plugs **F**.
Warning: Ensure not to damage any electric cable, water pipe or other devices while drilling holes.
- 4) Feed mains supply cable **G** through the pressure screw **I**, while setting mounting flange **A** in position. The pre-installed packing ring **H** is suitable for cable diameters 7 to 9.5 mm. For larger cable diameters (9 to 12 mm) use the auxiliary packing ring supplied. Then tighten the pressure screw **I** (Fig. I).
- 5) To fix mounting flange **A**, pierce through nylon plugs **P** by insert and tighten screws **D**.
Attention: Nylon plugs **P** must remain in position to provide sealing.
- 6) Check that rating shown on luminaire label conforms with mains electrical supply.
- 7) Connect mains supply cable **G** leads to respective terminals in terminal connector **C** (L = Phase, N = Neutral, ⊕ = Earthing).
- 8) Ensure that all surfaces are clean and dry. Position luminaire over mounting flange **A** and attach terminal connector **C**. Tighten screws **B**.
- 9) Loosen screws **M** and **N** slightly. Aim luminaire in desired direction, retighten screws **M** and **N**. Tighten set screw **O**.

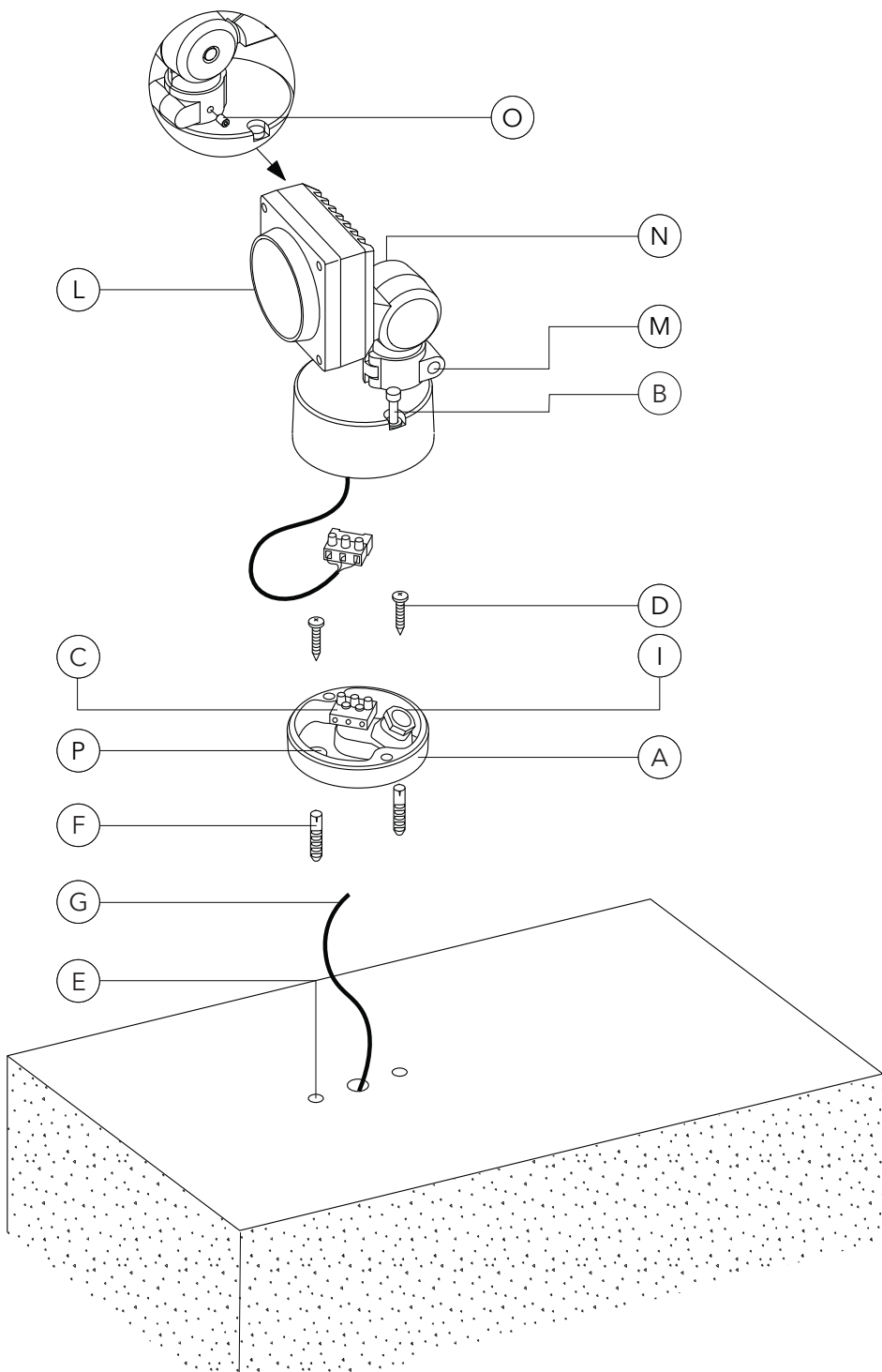

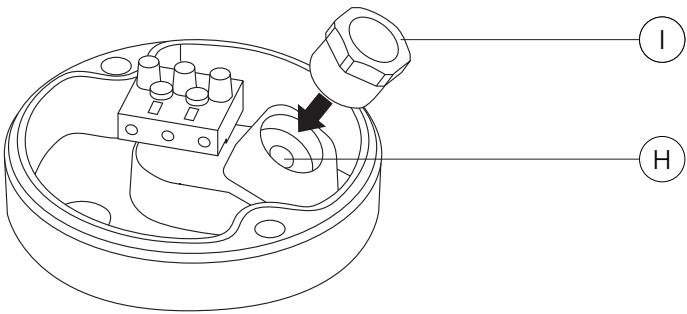

Fig. I

we-ef

www.we-ef.com

WE-EF LEUCHTEN

Germany

Tel +49 5194 909 0

Fax +49 5194 909 299

info.germany@we-ef.com

WE-EF LUMIERE

France

Tel +33 4 74 99 14 44

Fax +33 4 74 99 14 40

info.france@we-ef.com

WE-EF SWITZERLAND

Switzerland

Tel +41 22 752 49 94

Fax +41 22 752 49 74

info.switzerland@we-ef.com

WE-EF LIGHTING

Thailand

Tel +66 2 738 9610

Fax +66 2 175 2174

info.asiapacific@we-ef.com

WE-EF LIGHTING

Australia

Tel +61 3 8587 0444

Fax +61 3 8587 0499

info.australia@we-ef.com

WE-EF LIGHTING

United States of America

Tel +1 724 742 0030

Fax +1 724 742 0035

info.usa@we-ef.com

TO9218W0823 © WE-EF 2023

Technical specifications are
subject to change.

WE-EF LEUCHTEN

Installation and Maintenance
Instructions

Accessory

Short post



Accessories

Suitability

1. FLB100 Surface mounted
2. FLC300 Surface mounted
3. FLD100 Surface mounted

Short post

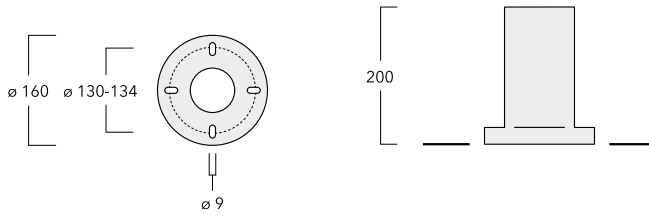

Installation

The product must be installed and maintained by a suitably qualified professional in compliance with latest building/construction and/or electrical regulations and relevant legislation.

The EM1-2 short post can be mounted either to a planted root or to an anchor bolt assembly secured in a cast concrete foundation. It is assumed that the mounting option chosen has been designed and constructed to satisfy prevailing load, location and soil type conditions, and is ready to receive the EM1-2 short post.

Warning: Switch off mains electrical supply prior to installing and connecting the luminaire.

Notice: If the luminaire is modified by anybody other than the original manufacturer, then the warranty will no longer be valid and shall become the full responsibility of the modifying person/organisation. Claims based on defects attributable to improper installation and/or application, and the consequences thereof, are excluded.

The installation on site must comply with local and/or national health and safety regulations.

Installation Procedure

- 1) Ensure mounting surface **A** is clean and free of debris.
- 2) Ensure anchor bolts **C** suit hole pattern in short post's flange plate **E** and feature appropriate, levelled protrusion from surface **A**.
- 3) Place rubber patch **I** on mounting surface **A**.
- 4) Mount short post **B**. Adjust nuts **D** and washers **H** on anchor bolts **C** and ensure the short post **B** is perpendicular to the ground.
- 5) Secure cover **F** by tightening cover screws **G** to the flange plate.

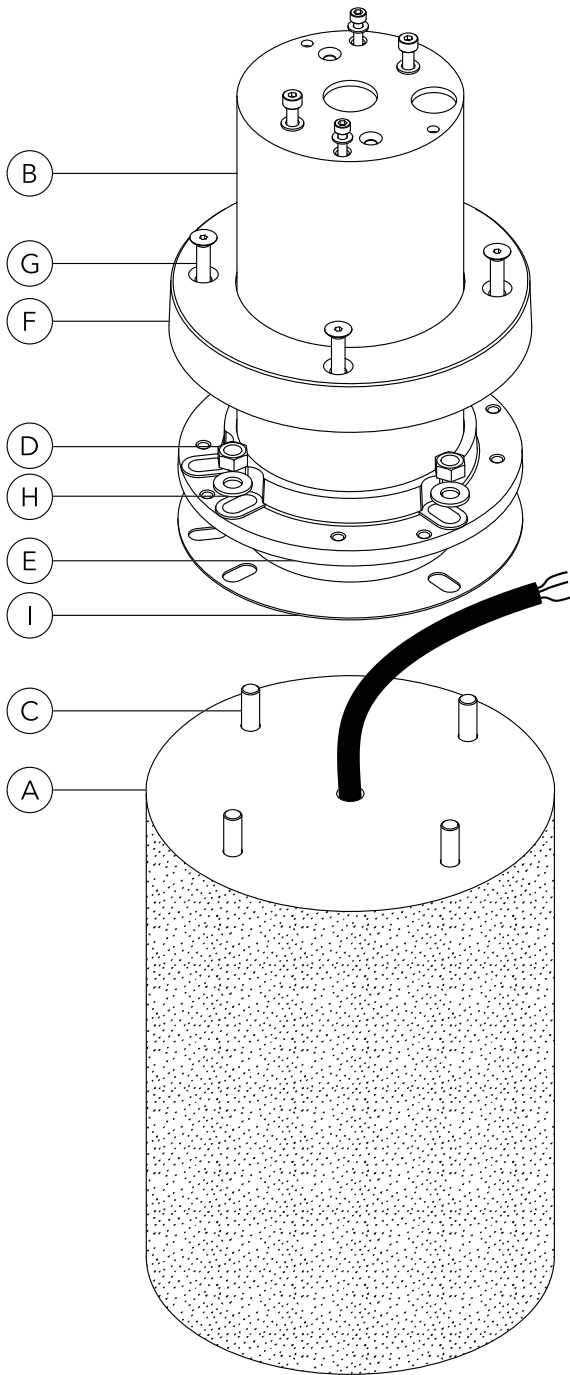

we-ef

www.we-ef.com

WE-EF LEUCHTEN

Germany

Tel +49 5194 909 0

Fax +49 5194 909 299

info.germany@we-ef.com

WE-EF LUMIERE

France

Tel +33 4 74 99 14 44

Fax +33 4 74 99 14 40

info.france@we-ef.com

WE-EF HELVETICA

Switzerland

Tel +41 22 752 49 94

Fax +41 22 752 49 74

info.switzerland@we-ef.com

WE-EF LIGHTING

Thailand

Tel +66 2 738 9610

Fax +66 2 175 2174

info.asiapacific@we-ef.com

WE-EF LIGHTING

Australia

Tel +61 3 8587 0444

Fax +61 3 8587 0499

info.australia@we-ef.com

WE-EF LIGHTING

United States of America

Tel +1 724 742 0030

Fax +1 724 742 0035

info.usa@we-ef.com

TO9221W0823 © WE-EF 2023

Technical specifications are
subject to change.