



## WE-EF LEUCHTEN

Installation and Maintenance  
Instructions

Projector  
**RAIL66 and Space frame**  
**FLC301**  
**FLC311**  
**FLC321**



### **Do not open during installation**

This product is factory-sealed.  
Refer to the instructions contained  
in this document for details.



### **Installation tools**

Mounting hardware used on this product  
includes fasteners with hexalobular  
socket heads (ISO 10664). Installation  
requires the use of matching tools.



### **Surge Protection**

This product features built-in surge protection circuitry in compliance  
with applicable standards.

For comprehensive protection of a luminaire installation against lightning  
and electrical surges, it is essential to cover mains supply and data input  
lines at the distribution board level, by using respective primary (Type 1)  
and secondary (Type 2) surge arrestors in compliance with EN61643-11/  
IEC61643-1.

### **Warning**

Ensure that all required surge protection measures are in place and  
activated prior to luminaire installation. Also, disconnect luminaires  
before operating high-power devices such as, for example, electrical  
arc welders.

**Projector**

**RAIL66**

**Space frame**

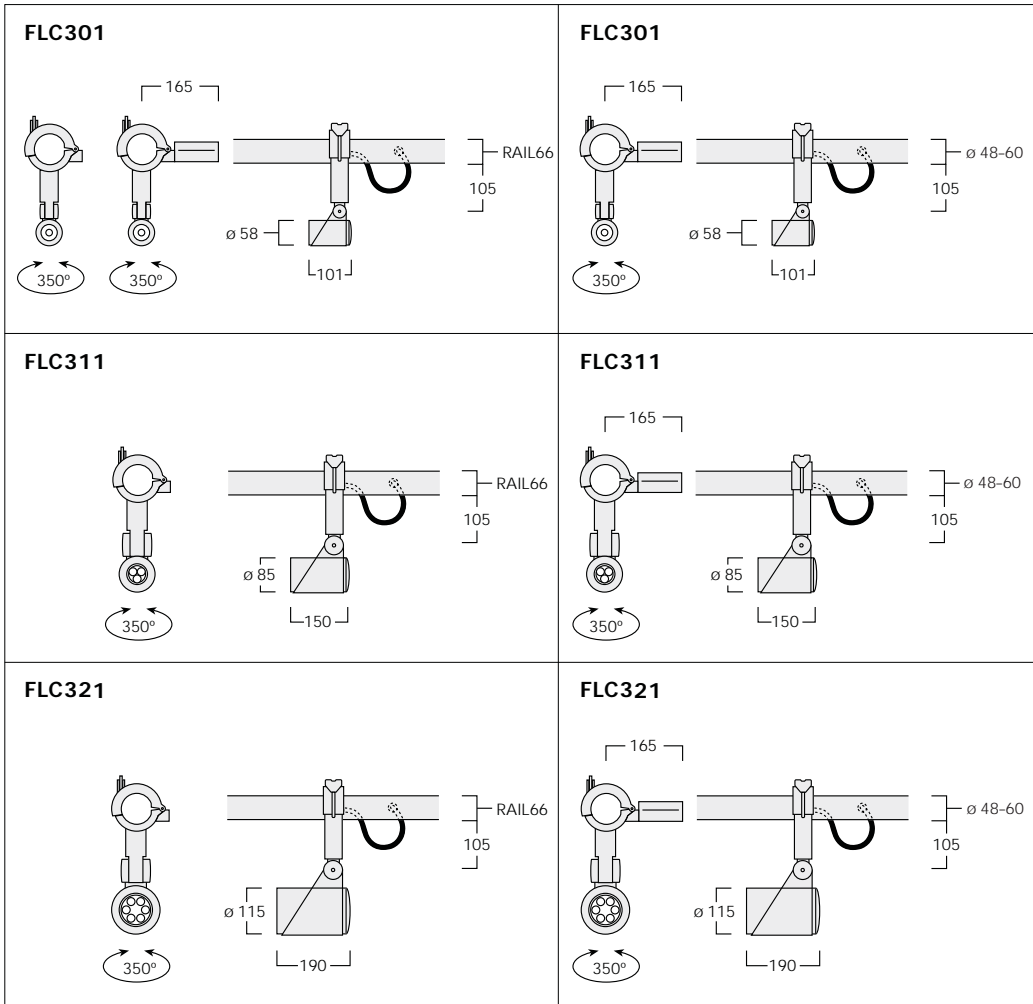

IP66, IK08. Class I.  $T_a = 40^{\circ}\text{C}$

Weight	kg
FLC301 RAIL66 with / without gearbox	1.9 / 1.2
FLC311 RAIL66 without gearbox	2.1
FLC321 RAIL66 without gearbox	2.5
FLC301 Space frame	1.7
FLC311 Space frame	3.4
FLC321 Space frame	3.7

**Light Source**

LED

**Maintenance**

Apart from cleaning the product's exterior surfaces, no special maintenance work is required.

Do not use high-pressure cleaners.

In case of component failure due to abnormal circumstances or at end of life, replacement must be carried out by a suitably qualified and trained professional.

**Warning:** Do not open luminaire while mains supply is switched on.

**Installation**

The product must be installed and maintained by a suitably qualified professional in compliance with latest building/construction and/or electrical regulations and relevant legislation.

**Warning:** Switch off mains electrical supply prior to installing and connecting the luminaire.

**Notice:** If the luminaire is modified by anybody other than the original manufacturer, then the warranty will no longer be valid and shall become the full responsibility of the modifying person/organisation. Claims based on defects attributable to improper installation and/or application, and the consequences thereof, are excluded.

The installation on site must comply with local and/or national health and safety regulations.

## Installation Procedure

**Installation - RAIL66 version:** Prior to installing the luminaire, mount and connect the selected RAIL66 mounting system in accordance with relevant installation instructions

- 1) Switch off mains electrical supply.

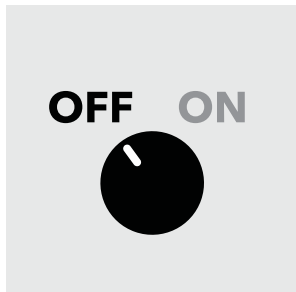

- 2) Check that rating shown on luminaire label conforms with mains electrical supply.

**we-ef** 07/20 IP66 **CE**  
**FLC301-LED** → 220-240V/50-60 Hz  
145-XXXX SOE XXXXXXXX  
LED 3000K 12W item no. XXX

(example)

- 3) Determine desired position of luminaire **A** on rail **X**, dependent on aiming requirements and proximity to a suitable mains outlet **Y**.

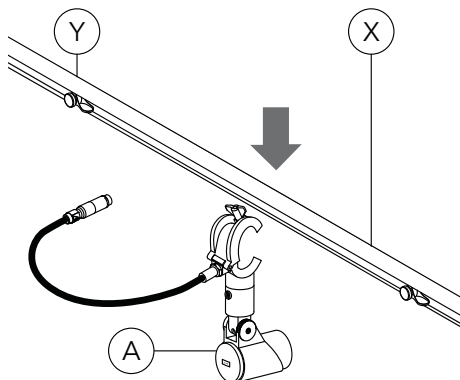

- 4) Attach clamp **B** to **X**. Tighten wingnut **C**.

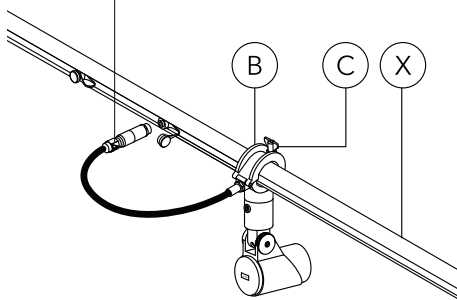

- 5) Remove protective cover **Z** from mains outlet **Y**. Insert in-line connector **G** and tighten.

**Attention:** On any mains outlet **Y'** that is not used, protective cover **Z'** must remain firmly secured. Check and ensure proper fit and tightness.

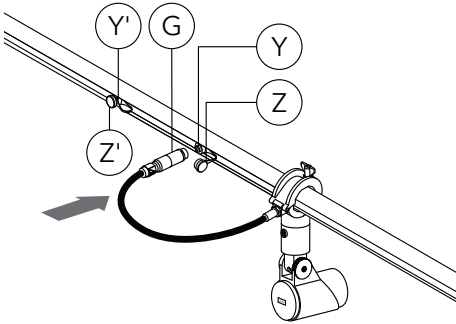

- 6) Loosen screws **H** and **I** slightly. Aim luminaire in desired direction, retighten screws **H** and **I**.

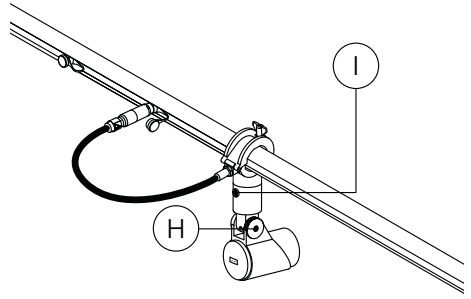

- 7) For accessory Linear Spread Lens IO-180:  
Turn frame **O** to set desired orientation of light.

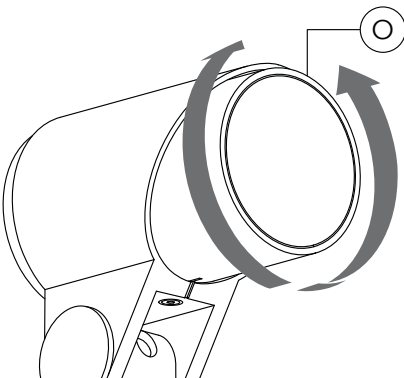

**Installation - Space frame version:** Suitable for space frame diameter 48-60 mm.

- 1) Switch off mains electrical supply.

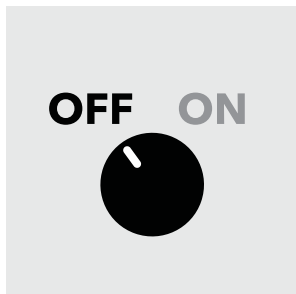

- 2) Check that rating shown on luminaire label conforms with mains electrical supply.

**we-ef** 07/20 IP66   
**FLC301-LED** → 220-240V/50-60 Hz  
145-XXXX SOE XXXXXXX  
LED 3000K 12W item no. XXX

(example)

- 3) Determine desired position of luminaire **A** on space frame **X**, dependent on aiming requirements. Attach clamp **B** to space frame **X**. Tighten wingnut **C**.

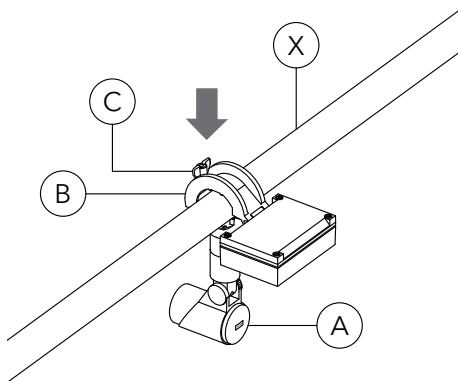

- 4) Detach gear box cover **D** by loosening screws **S**.

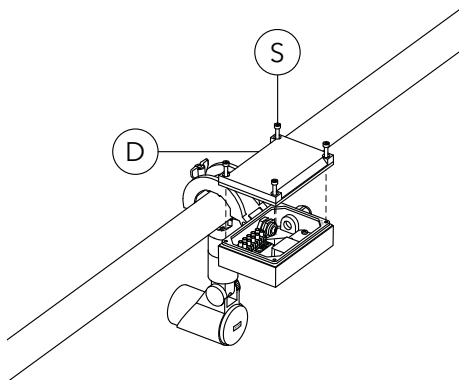

- 5) Feed mains supply cable **E** through cable gland **G** (Fig. I).

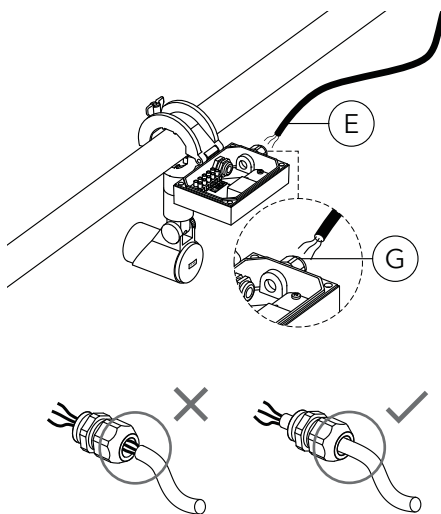

Fig. I

6) Connect mains supply cable **G** leads to respective terminals of socket **K**:

For **FLC301 / 311 / 321**:

- a) ON-OFF (L = Phase, N = Neutral, ⊕ = Earthing)
- b) 1-10V/DALI (L = Phase, N = Neutral, ⊕ = Earthing, DA/DA = DALI control line, D-/D+ = 1-10V control line)

Tighten cable gland **G**.

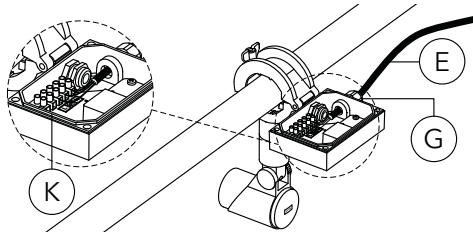

7) Reposition gear box cover **D** and secure in position by retighten screws **S**.

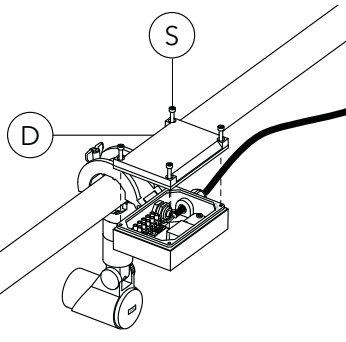

8) Loosen screws **H** and **I** slightly. Aim luminaire in desired direction, retighten screws **H** and **I**.

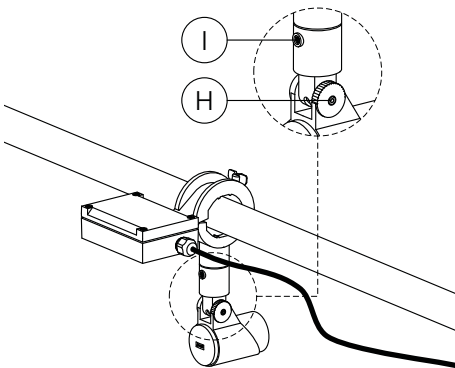

9) For accessory Linear Spread Lens IO-180:  
Turn frame **O** to set desired orientation of light.

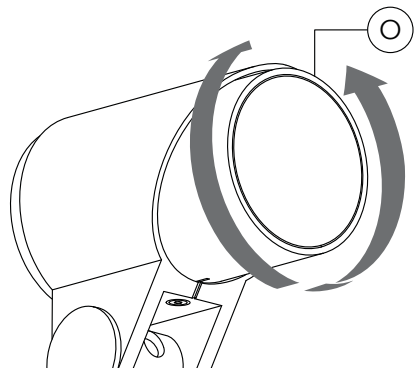

# **we-ef**

[www.we-ef.com](http://www.we-ef.com)

## **WE-EF LEUCHTEN**

Germany

Tel +49 5194 909 0

Fax +49 5194 909 299

[info.germany@we-ef.com](mailto:info.germany@we-ef.com)

## **WE-EF LUMIERE**

France

Tel +33 4 74 99 14 44

Fax +33 4 74 99 14 40

[info.france@we-ef.com](mailto:info.france@we-ef.com)

## **WE-EF SWITZERLAND**

Switzerland

Tel +41 22 752 49 94

Fax +41 22 752 49 74

[info.switzerland@we-ef.com](mailto:info.switzerland@we-ef.com)

## **WE-EF LIGHTING**

Thailand

Tel +66 2 738 9610

Fax +66 2 175 2174

[info.asiapacific@we-ef.com](mailto:info.asiapacific@we-ef.com)

## **WE-EF LIGHTING**

Australia

Tel +61 3 8587 0444

Fax +61 3 8587 0499

[info.australia@we-ef.com](mailto:info.australia@we-ef.com)

## **WE-EF LIGHTING**

United States of America

Tel +1 724 742 0030

Fax +1 724 742 0035

[info.usa@we-ef.com](mailto:info.usa@we-ef.com)

TO9273W0722 © WE-EF 2022

Technical specifications are  
subject to change.