

**we-ef**

# HIGHLIGHTS 2020

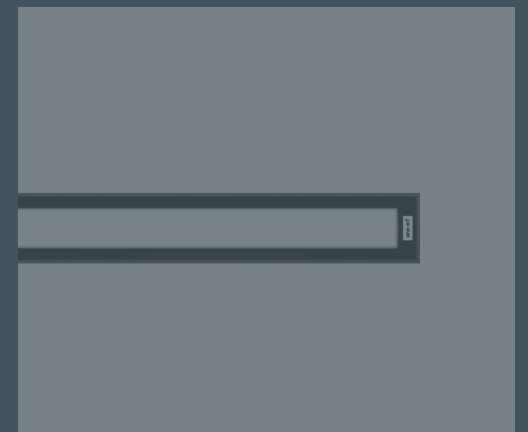
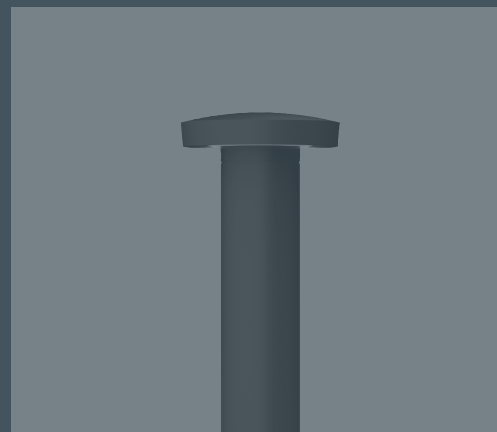
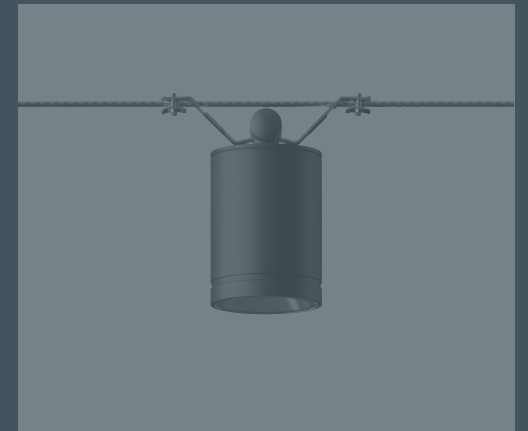
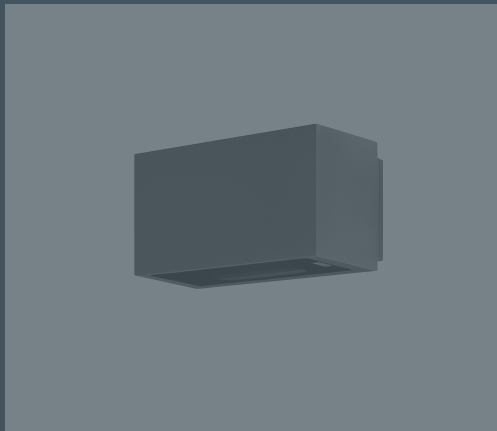
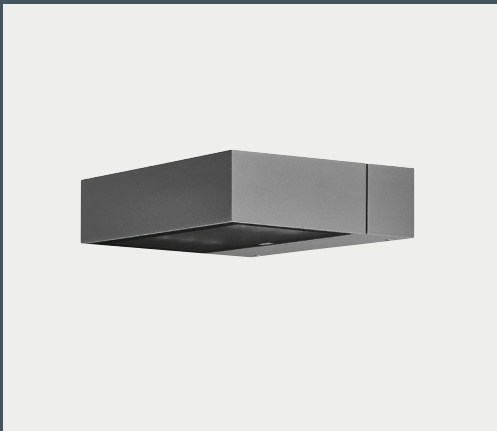

# INDEX

- PLS400 – Overview
- PLS400 – 3D
- PLS400 – Dimensions
- PLS400 – Catalogue

# PLS400 – Overview

## PLS400

Wall luminaire surface mounted

[S70]	Asymmetric, side-throw beam
[R65]	Rectangular, forward-throw beam
[A60]	Symmetric, forward-throw beam
[M]	Symmetric, medium beam
[E]	Symmetric, narrow beam

Light source PLS420: PCB 6 LED, XP-G2 @ 700mA; XP-L @ 1050mA and 1400mA  
2700K, 3000K and 4000K

Light source PLS430: PCB 12 LED, XP-G2 @ 700mA; XP-L @ 1050mA and 1400mA  
2700K, 3000K and 4000K

- IP66, IK08, Class I
- Marine-grade, die-cast aluminium alloy
- 5CE superior corrosion protection including PCS hardware
- Powdercoat finish RAL 9004, RAL 9006, RAL 9007, RAL 9016, RAL 7016
- Safety glass main lens
- CAD optimised PMMA-LED lenses
- Silicone CCG® Controlled Compression Gasket
- Integral EC electronic converter
- Surge protection  $\geq 1/2$  kV (SP10 not possible)
- PLS420: 1-10 V and DALI dimming  
PLS430: 1-10 V (only 700mA) and DALI dimming
- Factory sealed



# PLS400 – 3D

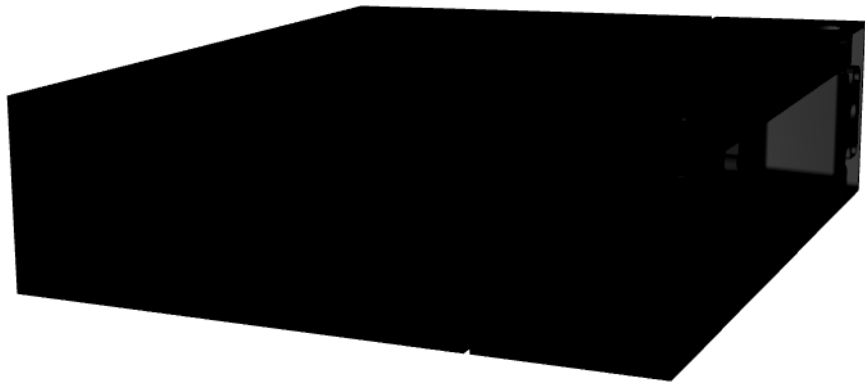

Click on image to rotate Product

# PLS400 – Dimensions

PLS420:

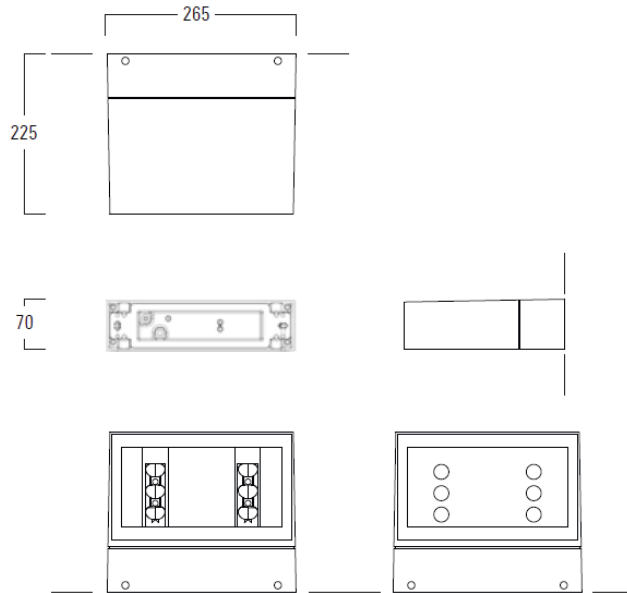

PLS430:

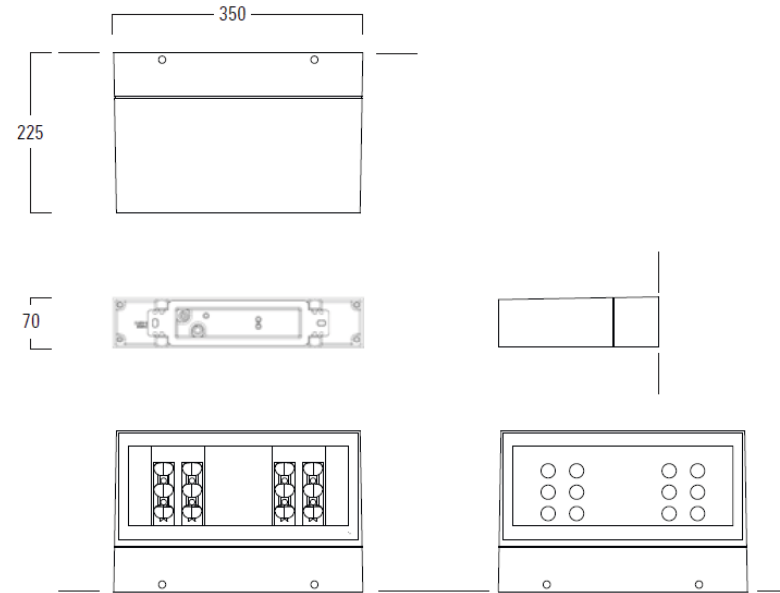

Available in 2 sizes

PLS400

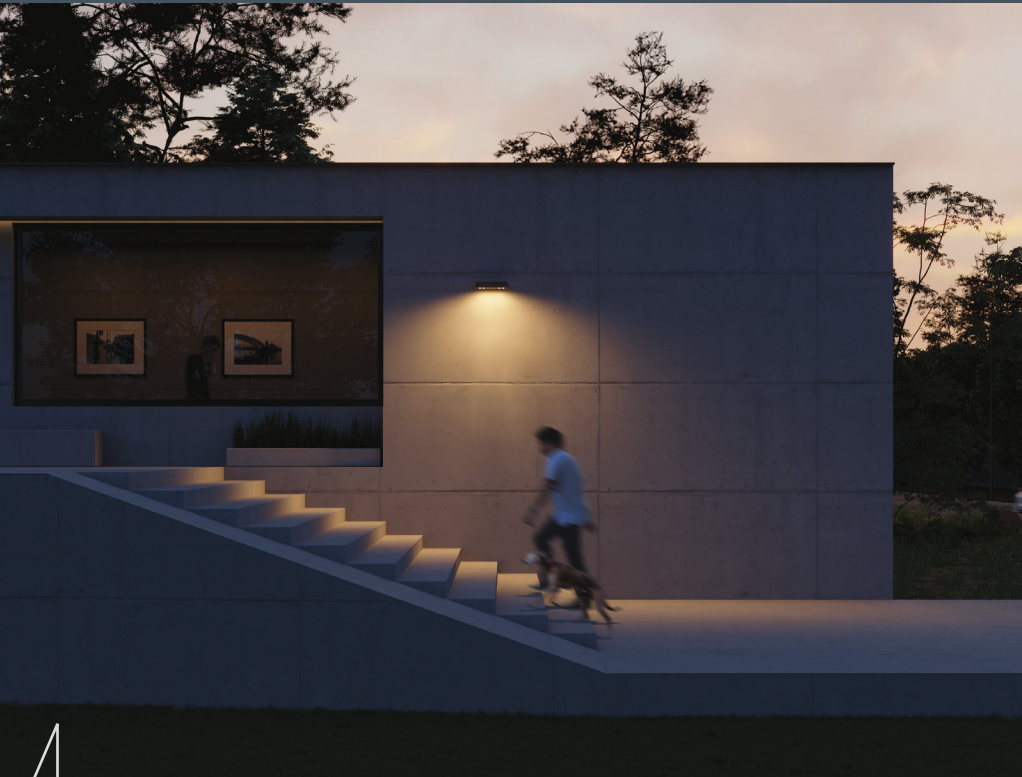

Luminaire housing: Marine-grade, die-cast aluminium alloy

Corrosion protection: 5CE, including PCS hardware

Driver: Integral EC electronic converter

Main lens: Safety glass

Gasketing: Silicone rubber gasket

Optics: CAD-optimised for superior illumination and glare control

OLC® One LED Concept

Installation: Two cable entries.

Luminaire is factory-sealed and does not need to be opened during installation

Control: Optional DALI version available. To be specified at time of ordering



Available distributions:  
[M] [E] [S70] [A60] [R65]

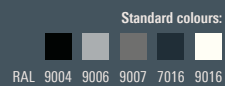

WALL SURFACE MOUNTED

**we-ef**

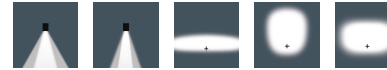

[M] Symmetric, medium beam  
[E] Symmetric, narrow beam  
[S70] Asymmetric 'side throw'  
[A60] Asymmetric 'forward throw'  
[R65] Rectangular 'side throw'

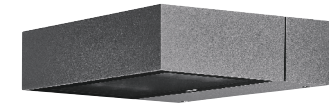

Suitable for downlighting, façade and uplighting applications

PLS420

[M] [E] [S70] [A60] [R65]

12-26 W  
800-2400 lm  
Max. 1 internal accessory

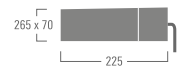

PLS430

[M] [E] [S70] [A60] [R65]

24-52 W  
1600-4800 lm  
Max. 1 internal accessory



For detailed specifications, product codes and latest performance data, refer to [www.we-ef.com](http://www.we-ef.com)  
Shown above are rated lumens for 3000 K at  $T_q = 25^\circ\text{C}$   
For accessories, refer to [www.we-ef.com](http://www.we-ef.com)

©WE-EF 2020

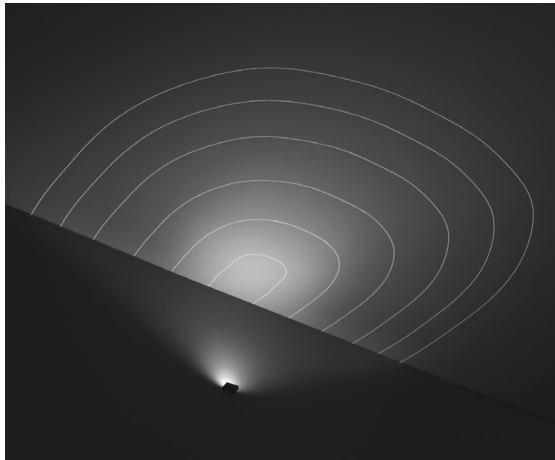

**PLS400 series**

With five different light distributions to choose from, the PLS400 series luminaires are ideal tools for a large variety of façade and area lighting applications, especially in an architectural setting.

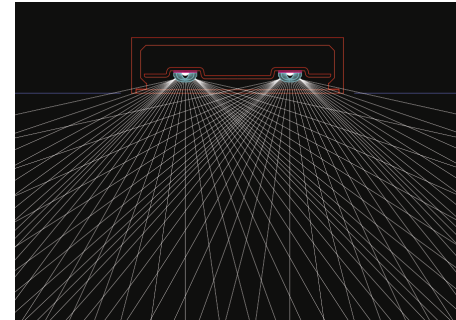

**PLS400 series – Ray-tracing**

The [S70] optical system allows for large spacing intervals between luminaires, as demonstrated in this typical application example.

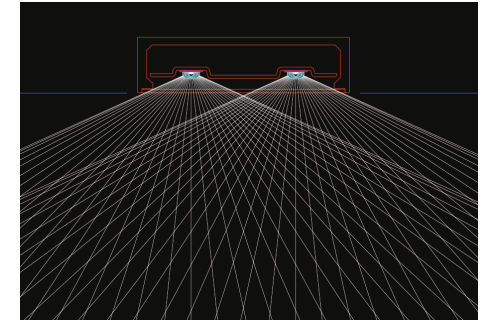

**PLS400 series – Ray-tracing**

The [R65] optics deliver rectangular 'side throw' distribution for applications where larger area coverage is required.

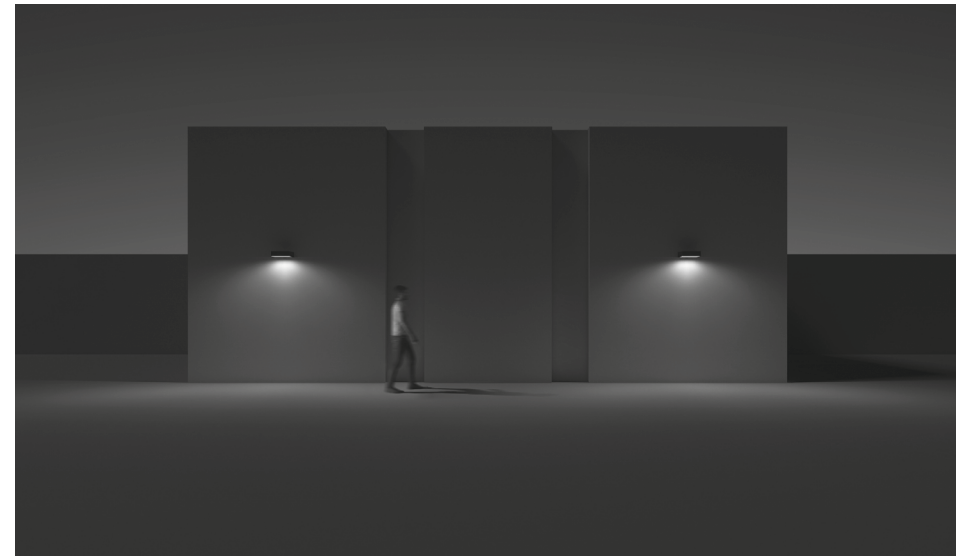

PLS400 series [S70]



**we-ef**

 [www.we-ef.com](http://www.we-ef.com)

 [weef\\_leuchten](https://www.instagram.com/weef_leuchten)

 [WE-EF LEUCHTEN](https://www.facebook.com/WE-EF-LEUCHTEN)

 [WE-EF Leuchten GmbH](https://www.linkedin.com/company/WE-EF-Leuchten-GmbH)

 [info@we-ef.com](mailto:info@we-ef.com)

